

# 免键胀套

## 台阶型 · 带定心功能

代码	类型		材质	表面处理
EUX16	台阶型	带定心功能	S45C	—
EUX17				喷砂镀镍
EUX18				发黑
EUX19			SUS304	—

※拆卸用螺孔

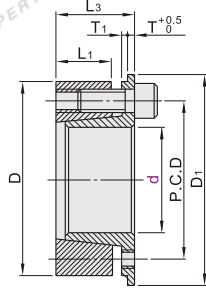
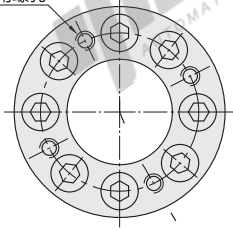

※拆卸用螺孔的螺径与锁紧螺栓相同。

视角标准：第一视角

型号	D	D <sub>1</sub>	P.C.D	L <sub>1</sub>	L <sub>3</sub>	T	T <sub>1</sub>	紧固螺钉		容许最大扭矩(N·m)			容许轴向负载(kN)			螺栓紧固扭矩(N·m)			
								M×L	个数	EUX16 EUX18	EUX17	EUX19	EUX16 EUX18	EUX17	EUX19	EUX16	EUX18	EUX17	EUX19
<b>5</b>	16	18.5	11.7	8	13	1.8	1.2	M3×L10		7	4.6	2.8	2.8	1.84	1.13	1.9	1.6	1.9	0.88
<b>6</b>	19	21.5	14	9	14.3	2.0	1.3	M4×L12	4	22	16.6	10.7	5.6	4.1	2.64				
<b>8</b>	21	23.5	15.4	9.3	14.6	2.0	1.3		25	19.6	12.7	5.6	3.9	2.55					
<b>10</b>	23	25.5	17.5	9.5	15.8			1.5	6	30	22.5	14.7	5.6	4	2.64				
<b>12</b>	26	28.5	20.2			10.5	18.0			2.5	M4×L15	50	36.2	24.5	8.41	5.9	4.02		
<b>14</b>	28	30.5	22.2	11.5	19.0	1.6	8	65	50.9	28.4		9.46	7.2	4.02	3.9	3.2	3.9	2.7	
<b>15</b>	29	31.5	23.2					12.5	20.1	1.8	10	70	54.8	30.4	9.46	7.2	4.02		
<b>16</b>	30	33.0	24.2	12.5	20.1	3.5	10	75	58.8			32.3	9.46	7.3	4.02				
<b>17</b>	31	33.5	25.2					15.3	24.1	4.0	10	110	76.4	46.1	12.6	8.9	5.39		
<b>18</b>	32	34.5	26.2	16.3	25.1	4.5	10					115	80.3	49.0	12.6	8.9	5.39		
<b>19</b>	33	35.5	27.2					17.3	26.6	2.0	12	120	85.2	51.9	12.6	8.9	5.39		
<b>20</b>	38	42.0	30.8	17.3	26.6	2.0	12					220	183	121.6	21.6	18.3	12.16		
<b>22</b>	40	44.0	32.8					16.3	25.1	4.0	10	290	201	133.4	26	18.3	12.06		
<b>24</b>	42	46.0	34.8	20.5	31.0	4.5	14					320	252	146.1	26	21	12.16		
<b>25</b>	43	47.0	35.8					20.5	31.0	4.5	14	350	264	153.0	27.2	21.1	12.16	8.8	7.5
<b>28</b>	46	50.0	38.8	21.0	32.0	4.5	14					380	295	213.8	27	21.1	15.20		
<b>30</b>	48	52.0	40.8					21.5	32.5	5.0	15	410	396	229.5	27	26.4	15.30		
<b>32</b>	50	54.0	42.8	21.5	32.5	5.0	15					440	423	244.2	27	26.4	15.20		
<b>35</b>	57	62.0	48.4					20.5	31.0	4.0	10	720	548	301.1	41.1	31.3	17.16		
<b>38</b>	60	65.0	51.4	20.5	31.0	4.0	10					770	741	409.0	40.2	39	21.48		
<b>40</b>	62	67.0	53.4					21.0	31.5	4.0	10	810	779	430.6	40.2	39	21.48		
<b>42</b>	64	69.0	55.4	21.0	31.5	4.0	10					850	823	452.2	40.2	39.2	21.48		
<b>45</b>	67	72.0	58.4					21.0	32.0	2.0	12	1200	882	484.6	52.9	39.2	21.48	15.7	12.7
<b>48</b>	70	75.0	61.4	21.5	32.5	4.5	14					1200	1117	620.9	48.2	46.5	25.80		
<b>50</b>	72	77.0	63.4					22.0	33.5	5.0	15	1500	1362	754.3	56.3	54.4	30.11		
<b>55</b>	77	83.0	68.4	22.0	33.5	5.0	15					1600	1512	—	56.3	55	—		
<b>60</b>	82	87.0	73.4					22.0	33.5	5.0	15	1900	1768	—	60.3	58.9	—		
<b>65</b>	87	92.0	78.4									2000	1915	—	60.3	58.9	—		



请按图示订货

型号		D	D <sub>1</sub>
代码	d		
EUX16	10	23	25.5
EUX17	11	24	26.5

EUX16—d11



Example 使用示例

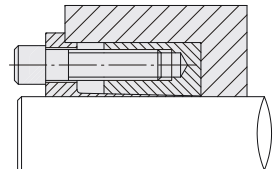

未税价(元)

优惠价

数量	1~4	5~
价格	100%	另行报价



交货期

5