

无油线性滑板

两面研磨型 · 锥孔型/沉孔型 铜合金

代码	类型	线性滑板厚度	材质
OBG01	锥孔型	3	高力黄铜(SP2) 镶嵌固体润滑剂
OBG02	锥孔型	5	
OBG11	沉孔型	5	
OBG12	沉孔型	10	



无油衬套

E1

OBG01
(板厚3mm)

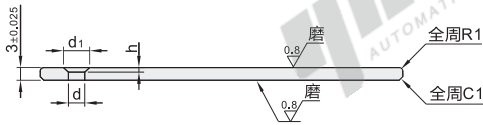

OBG02
(板厚5mm)

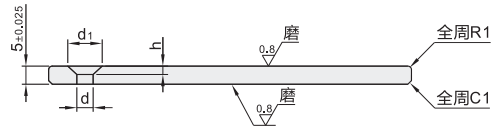

OBG11
(板厚5mm)

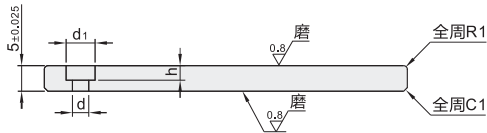

OBG12
(板厚10mm)

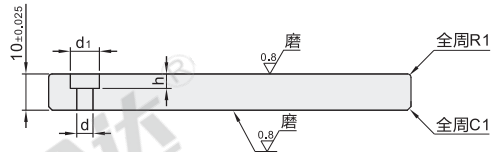

1K(1孔)

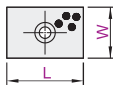

2K(2孔)

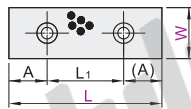

3K(3孔)

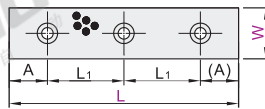

4K(4孔)

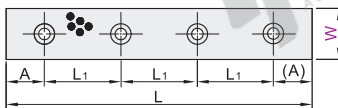

5K(5孔)

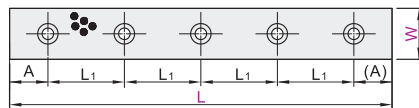

4K(4孔)

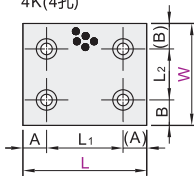

6K(6孔)

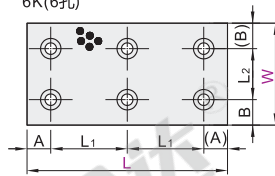

8K(8孔)

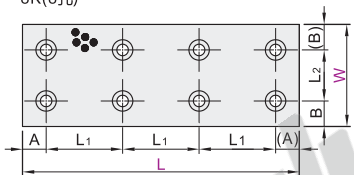

10K(10孔)

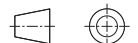
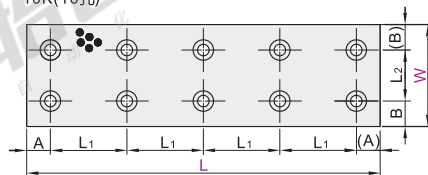

视角标准：第一视角

① OBG11仅有W尺寸20规格。 ② OBG01仅适用于L () 尺寸。

型号 代码	W	L	安装 孔位	孔位置	A	L ₁	B	L ₂
锥孔型 (板厚3mm) OBG01 (板厚5mm) OBG02	20	(30)	1		—	—		
		(40)				20		
		(50)				30		
		(60)	2			40		
		80			10	60		
		100				40		
	沉孔型 (板厚5mm) OBG11 (板厚10mm) OBG12	120	3			50		
		150				65		
		200	4			60		
		250				60		
		300	5			13	56	
		(40)				14	68	
30	40	(30)	1	1列	—	—		
		(40)				20		
		(50)				30		
		(60)	2			40		
		80			10	60	—	—
		100				40		
	40	120	3			50		
		150				65		
		200	4			60		
		250				13	56	
		300	5			14	68	
		(40)				—	—	
50	60	(40)	1		—	—		
		(50)				40		
		(60)	2			10	60	
		80				40		
		100				38		
		120	3			12	48	
	80	150				63		
		200	4			13	58	
		250				56		
		300	5			14	68	
		(40)				—	—	
		(60)				—	—	

型号 代码	W	L	安装 孔位	孔位置	A	L ₁	B	L ₂
锥孔型 (板厚5mm) OBG02 (板厚10mm) OBG12	50	50	1		—	—		
		60				40		
		80	2			10	60	
		100				37		
		120	3			47		
		150				62		
	60	200	4			58		
		250				56		
		300	5		1列	14	68	—
		60				40		
		80	2			10	60	
		100				37		
80	120	3			47			
	150				62			
	200	4			58			
	250	5			56			
	300				14	68		
	80				10	60		
100	100	4			74			
	120				47			
	150	6		2列	13	62	20	
	200				87			
	250	8			74			
	300	10			14	68		

无油衬套

E1

孔加工详图

OBG01 (内六角沉头螺钉孔)

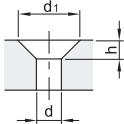

W	d	d ₁	h	螺钉规格
20	4.3	9.5	2.5	M4-20
30	—	—	—	—
40	5.3	11.1	2.8	M5-20

OBG11(内六角薄圆柱头螺钉孔)

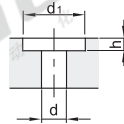

W	d	d ₁	h	螺钉规格
20	4.3	8	3	M4-10

OBG02 (内六角沉头螺钉孔)

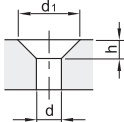

W	d	d ₁	h	螺钉规格
20	4.3	9.5	2.5	M4-20
30	5.3	11.1	2.8	M5-20
40	6.5	13.1	3.3	M6-20
50	—	—	—	—
60	8.5	17.6	4.3	M8-20

OBG12(内六角薄圆柱头螺钉孔)

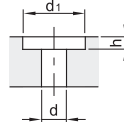

W	d	d ₁	h	螺钉规格
20	4.3	8	4.2	M4-20
30	5.3	9.5	5.2	M5-20
40	6.5	11	6.2	M6-20
50	—	—	—	—
60	8.5	15	6.2	M8-20
80	—	—	—	—

① 螺钉需另行购买，锥孔型推荐螺钉型号TAU01，沉孔型推荐螺钉型号TAF01。



请按图示订货

型号	W	L
OBG01	20	(30)
OBG02	20	(40)

OBG01—W20—L30



未税价(元)

● 优惠价

数量	1~9	10~
价格	100%	另行报价



交货期

7