

代码	类型		材质	表面处理
HFS01	螺孔型	不锈钢蝶形铰链专用	SUS304	—
HFS06		铝合金/树脂铰链专用		

孔数: 2

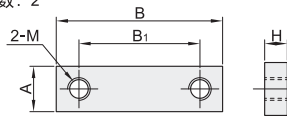

孔数: 3

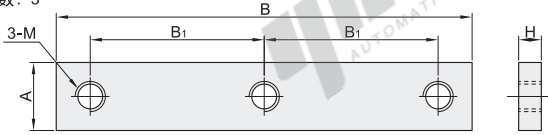

孔数: 4

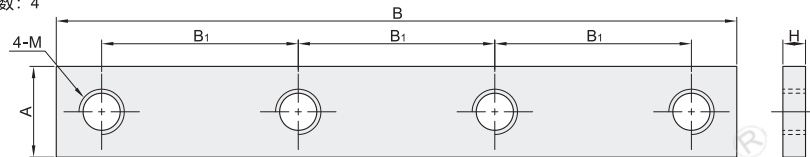

EX Example 使用示例

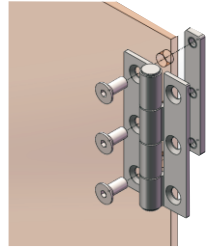

视角标准: 第一视角

代码	型号	规格	孔数	A	B	B1	M	H
HFS01		19	2	6	19	13	3	3
		22		6	22	16		
		28		6	28	22		
		32		6	32	24		
		36	7	36	28	4		
		39	6	39	30			
		45	7	45	36			
		55	9	55	23			
		57	6	57	24	3		
		65	11	65	27	5		
		65A	6	65	28	3		
		79	6	79	35			
		82	12	82	35			
		87	6	87	26		6	
90	12	90	26	6				
HFS06		33	2	14	33	20	6	
		34		9	34	25		
		38		16	38	25		
		40		10	40	30		
		48	18	48	30	5		
		49	12	49	37			
		55	12	55	43			
		59	9	59	25			
		70	10	70	30			
		86	12	86	37			
98	12	98	43	6				



请按图示订货

型号	规格	孔数
代码 HESD1	规格 C19 22	2
HFS01-19		



未税价(元)

● 优惠价

数量	1~9	10~
价格	100%	另行报价



交货期

1

适用蝶形铰链	孔数	蝶形铰链适用螺帽	蝶形铰链适用螺帽	适用蝶形铰链
HFC21-35B/HFC21-48/HFC21-62/HFC21-79A	2	HFS01-19	HFS01-19	HFV14-25
HFC06-48-W(E)/HFC06-59-W(E)/HFC06-70-W(E)		HFS01-22	HFS01-22	HFV11-25
HFC26-47/HFC26-47A/HFC26-63		HFS01-28	HFS01-28	HFV11-30
HFC91-47/HFC91-47A/HFC91-47B/HFC91-63/HFC91-63A/HFC91-63B		HFS01-32	HFS01-32	HFV14-40
HFV01-35/HFV01-47/HFV01-61		HFS06-34	HFS01-36	HFV11-40A
HFC41-48/HFC41-62		HFS06-40	HFS01-39	HFV14-50
HFC22-35B/HFC22-48/HFC22-62/HFC22-79A		HFS06-49	HFS01-45	HFV11-50A
HFV13-40/HFV13-65/HFV13-47/HFV13-77/HFV13-58/HFV13-95		HFS06-55	HFS01-55	HFV11-65
HFC28-47/HFC28-47A/HFC28-63			HFS01-57	HFV14-65
HFC27-47/HFC27-47A/HFC27-63			HFS01-65	HFV11-75
HFG02-47/HFG02-63/HFG02-63A			HFS01-65A	HFV14-75
HFC31-48/HFC31-62			HFS01-79	HFV14-90
HFC23-63			HFS01-82	HFV11-90
HFC24-63A			HFS01-87	HFV14-100
HFV13-40/HFV13-65		HFS01-90	HFV11-100	
HFV13-47/HFV13-77	3	HFS06-59		
HFV13-58/HFV13-95		HFS06-70		
HFV13-70/HFV13-113		HFS06-86		
		HFS06-98		
HFC71-35/HFC71-40/HFC71-50/HFC71-50A	2	HFS06-33		
HFC76-55/HFC76-64/HFC76-64A		HFS06-38		
HFC78-55/HFC78-64/HFC78-64A		HFS06-48		
HFC74-35/HFC74-40/HFC74-50/HFC74-50A				

铰链