

代码	类型	插芯	材质
ZKW07	DD型超高密度型连接器	插芯	聚碳酸酯

CQC CE



24芯

M (公)

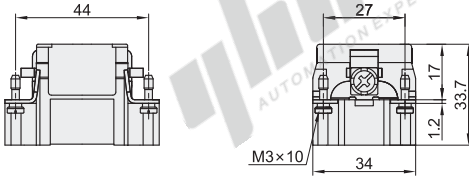

F (母)

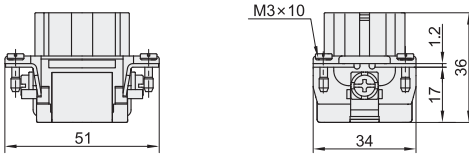

① 接插体之间最大距离21mm

42芯

M (公)

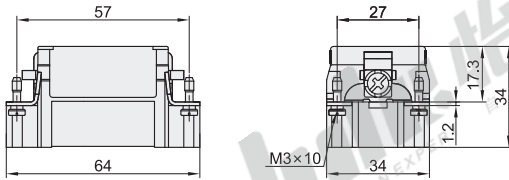

F (母)

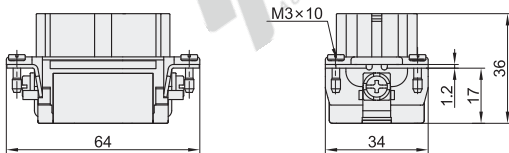

① 接插体之间最大距离21mm

72芯

M (公)

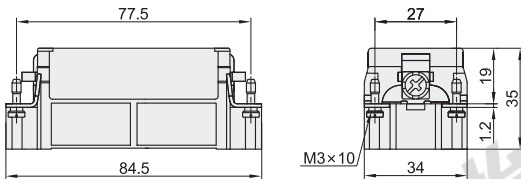

F (母)

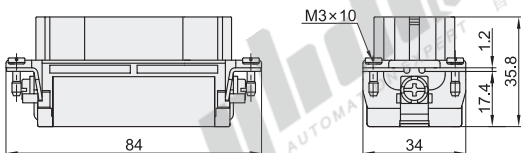

① 接插体之间最大距离21mm

接插针排序

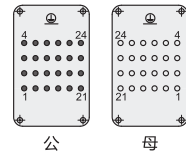

面板安装开孔图

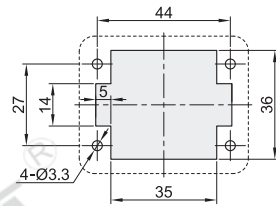

接插针排序

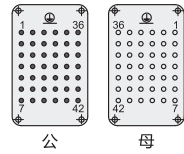

面板安装开孔图

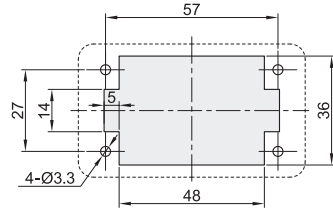

接插针排序

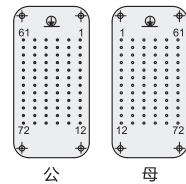

面板安装开孔图

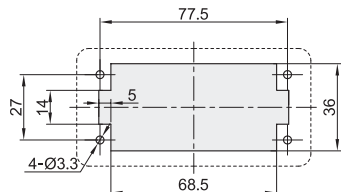

视角标准：第一视角

高性价比型重载连接器

◀ DD型超高密度型插芯

连接器

108芯

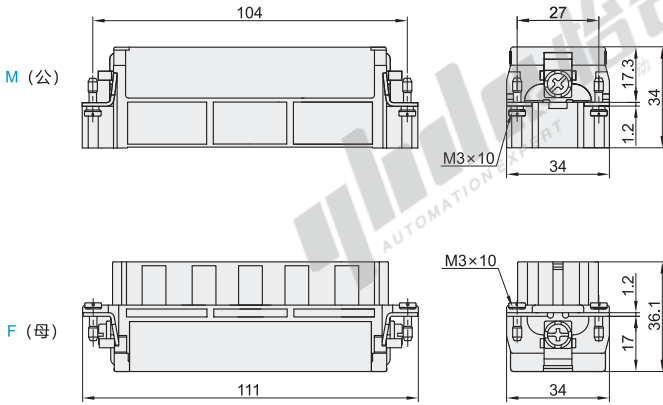

接插针排序

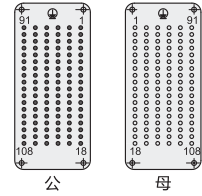

面板安装开孔图

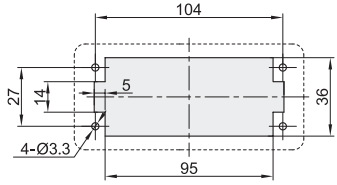

接插体之间最大距离21mm

型号		接插件类型	接线方式	适配外壳	适配插针
代码	芯数				
ZKW07	24 (24芯)	M (公)	C (冷压连接)	ZKW13 ZKW14	ZKW20
	42 (42芯) 72 (72芯) 108 (108芯)	F (母)			

技术参数

额定电流	10A
额定电压	250V
额定脉冲电压	4KV
污染程度	3
污染等级2时的参数	10A 230/400V 4KV 2
依据UL/CSA额定电压	600V
绝缘电阻	$\geq 10^{10}\Omega$
工作温度范围	$-40^{\circ}\text{C} \sim +125^{\circ}\text{C}$
依据UL94阻燃等级	V0
可拔插次数	≥ 500

电流负载能力

电流负载能力所受的限制主要来自包含接插针的接插体可承受的最大温度测试和控制过程依据DIN EN 60512-5

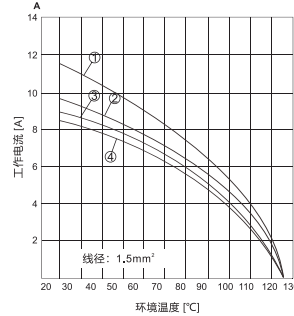
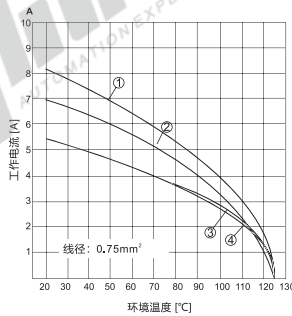

①ZKW07-24-M/F
②ZKW07-42-M/F
③ZKW07-72-M/F
④ZKW07-108-M/F



请按图示订货

型号		接插件类型	接线方式
代码	芯数		
ZKW07	24 (24芯) 42 (42芯)	M (公) F (母)	C (冷压连接)

ZKW07-24-M-C

