

# 无油线性滑板

## 两面研磨型 · 锥孔型/沉孔型 铜合金

代码	类型	线性滑板厚度	材质
OBG01	锥孔型	3	高力黄铜(SP2) 镶嵌固体润滑剂
OBG02	锥孔型	5	
OBG11	沉孔型	5	
OBG12	沉孔型	10	

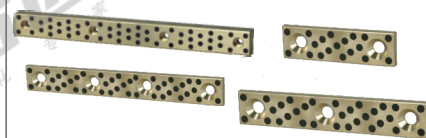

OBG01  
(板厚3mm)

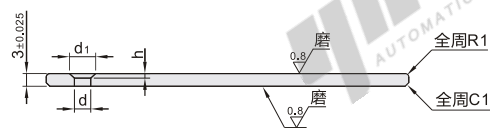

OBG02  
(板厚5mm)

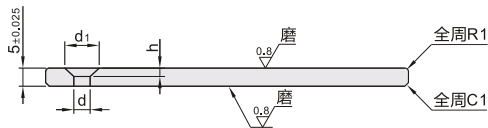

OBG11  
(板厚5mm)

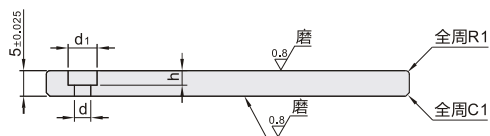

OBG12  
(板厚10mm)

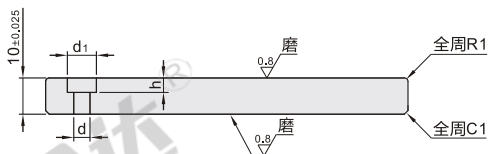

1K (1孔)

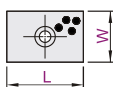

2K (2孔)

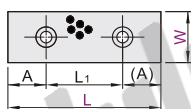

3K (3孔)

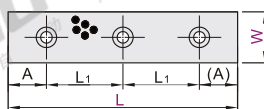

4K (4孔)

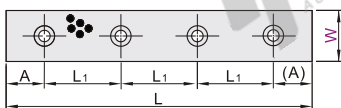

5K (5孔)

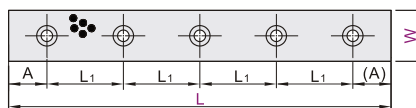

4K (4孔)

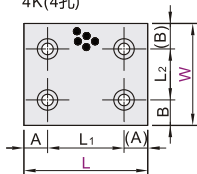

6K (6孔)

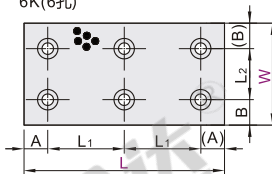

8K (8孔)

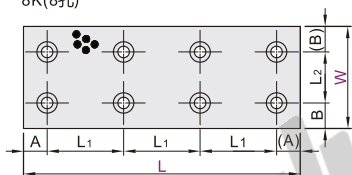

10K (10孔)

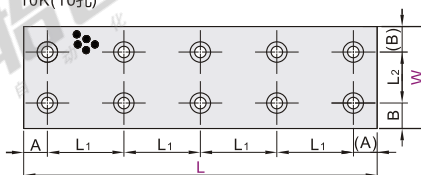

□ 未注尺寸公差按GB/T 1804-M执行。

视角标准：第一视角

① OBG11仅有W尺寸20规格。 ② OBG01仅适用于L ( ) 尺寸。

型号 代码	W	L	安装 孔位	孔位置	A	L <sub>1</sub>	B	L <sub>2</sub>	
锥孔型 (板厚3mm) OBG01	20	(30)	1		—	—			
		(40)				20			
		(50)					30		
		(60)					40		
		80				10	60		
	100					40			
	120					50			
	150					65			
	200					60			
	250					13	56		
	300					14	68		
	(30)					—	—		
	(40)					20			
	(50)					30			
	(60)					40			
80				1列	10	60	—	—	
100					40				
120					50				
150					65				
200					60				
250					13	56			
300					14	68			
(40)					—	—			
(60)					10	40			
80					10	60			
100						38			
120					12	48			
150						63			
200					13	58			
250						56			
300					14	68			
沉孔型 (板厚5mm) OBG11	30	(30)	1						
		(40)				20			
		(50)					30		
		(60)					40		
		80					60		
	100					40			
	120					50			
	150					65			
	200					60			
	250					13	56		
	300					14	68		
	(40)					—	—		
	(60)					10	40		
	80					10	60		
	100						38		
120					12	48			
150						63			
200					13	58			
250						56			
300					14	68			
沉孔型 (板厚10mm) OBG12	40	(30)	1						
		(40)				20			
		(50)					30		
		(60)					40		
		80					60		
	100					40			
	120					50			
	150					65			
	200					60			
	250					13	56		
	300					14	68		
	(40)					—	—		
	(60)					10	40		
	80					10	60		
	100						38		
120					12	48			
150						63			
200					13	58			
250						56			
300					14	68			

型号 代码	W	L	安装 孔位	孔位置	A	L <sub>1</sub>	B	L <sub>2</sub>	
锥孔型 (板厚5mm) OBG02	50	50	1		—	—			
		60				40			
		80				10	60		
		100					37		
		120					47		
	150					62			
	200					58			
	250					56			
	300					14	68	—	—
	60					40			
	80					10	60		
	100						37		
	120					47			
	150					62			
	200					58			
250					56				
300					14	68			
80					10	60			
100						74			
120					47				
150					62	20	40		
200					87				
250					74				
300					14	68			

孔加工详图

OBG01 (内六角沉头螺钉孔)

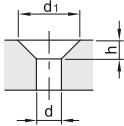

W	d	d <sub>1</sub>	h	螺钉规格
20	4.3	9.5	2.5	M4-20
30	—	—	—	—
40	5.3	11.1	2.8	M5-20

OBG11(内六角薄圆柱头螺钉孔)

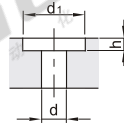

W	d	d <sub>1</sub>	h	螺钉规格
20	4.3	8	3	M4-10

OBG02 (内六角沉头螺钉孔)

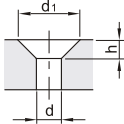

W	d	d <sub>1</sub>	h	螺钉规格
20	4.3	9.5	2.5	M4-20
30	5.3	11.1	2.8	M5-20
40	6.5	13.1	3.3	M6-20
50	—	—	—	—
60	8.5	17.6	4.3	M8-20

OBG12(内六角薄圆柱头螺钉孔)

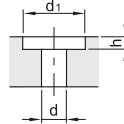

W	d	d <sub>1</sub>	h	螺钉规格
20	4.3	8	4.2	M4-20
30	5.3	9.5	5.2	M5-20
40	6.5	11	6.2	M6-20
50	—	—	—	—
60	8.5	15	6.2	M8-20
80	—	—	—	—

① 螺钉需另行购买，锥孔型推荐螺钉型号TAU01，沉孔型推荐螺钉型号TAF01。



请按图示订货

型号	代码	W	L
OBG01	20	(30)	(40)
OBG02	20	(30)	(40)

OBG01—W20—L30



未税价(元)

● 优惠价

数量	1~9	10~
价格	100%	另行报价



交货期

7