

定位块

凹槽型 V形槽

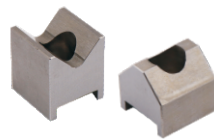

代码	类型		材质		硬度
			国标	相当	
PDE21	V形槽	标准型	45	S45C	40~43HRC
PDE22		螺孔型			
PDE23		加长型			

标准型 PDE21
螺孔型 PDE22
下部

标准型
上部

螺孔型
上部

加长型 PDE23
下部

上部

组装尺寸
标准型/加长型

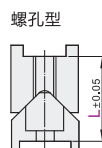
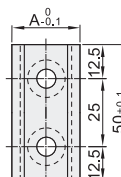
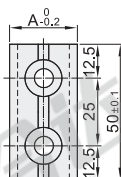
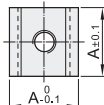
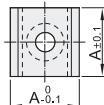
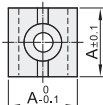
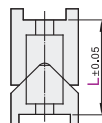
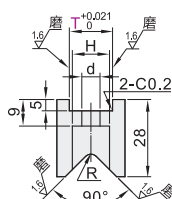
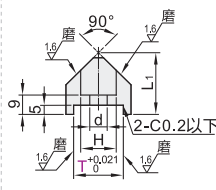
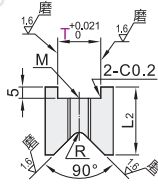
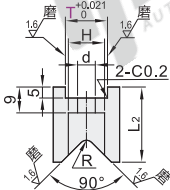
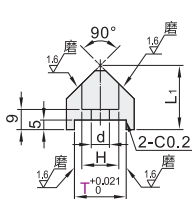

视角标准：第一视角

型号		L	L1	L2	A	H	d	R	M
代码	T								
PDE21	12	35	25	26	20	9.5	5.5	2	—
	16		27	28	25	14	9	4	—
	19		19	22	20	9.5	5.5	2	—
	12	25	21	24	25	11	7	4	—
	16		21	24	25	11	7	4	—
PDE22	16	35	27	28	25	14	9	4	M8
	16	25	21	24	25	11	7	4	M6
PDE23	12	35	25	26	20	9.5	5.5	2	—
	16		27	28	25	14	9	4	—
	19		19	22	20	9.5	5.5	2	—



型号		L	L1	L2
代码	T			
PDE21	12	35	25	26
	16		27	28
	19		19	22

PDE21—T19—L35



优惠价	
数量	1~9 10~
价格	100% 另行报价

