

气缸用连接头

◀ 凹型
◀ 凸型

代码	类型	材质	表面处理
ZFA11	凹型	S45C	镀硬铬
ZFA12		SUS304	—
ZFA13	凸型	S45C	镀硬铬
ZFA14		SUS304	—



凹型
ZFA11/12

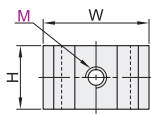
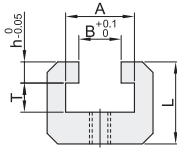

凸型
ZFA13/14

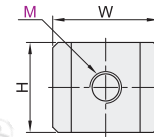
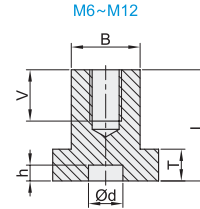
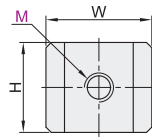
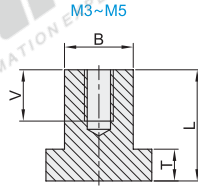

视角标准：第一视角

凹型

型号		M	W	H	L	T	A	B	h
(S45C) ZFA11	3	20	10	14.5			10	7	
	4		12	16.5			13	8	
	5	22	14	18.5			15.4	9	4
(SUS304) ZFA12	6	24	16.5	20.5	4.5		17.5	11	
	8	30	20	26.5			21	14	6
	10	40	25	32.5			25.5	18	
	12	45	26.5	36.5			28.5	20	8

凸型

型号		M	V	W	H	L	T	B	h	d
(S45C) ZFA13	4	6	12	10	11			7		
	5	7.5	14	12	13		3	8		
	6	9	16.5	14	16			10		6.5
(SUS304) ZFA14	8	12	20	17	20		4	13	3	
	10	15	25	22	24			16		10.5
	12	18	27	24	28			18		



请按图示订货

凹型

型号		M	W
代码	3	20	
ZFA11	4		20

ZFA11—M4



未税价(元)

优惠价

数量	1~9	10~
价格	100%	另行报价



交货期

7