

高品质型重载连接器

◀ E型下壳

连接器

代码	类型	外壳材质	密封元件	锁扣
ZKW33	高品质型	铸铝合金	NBR(丁腈橡胶)	不锈钢软胶套

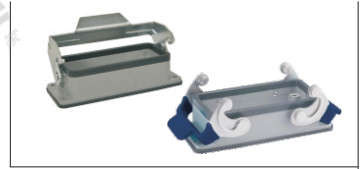

规格: 6B
锁扣方式: 单扣

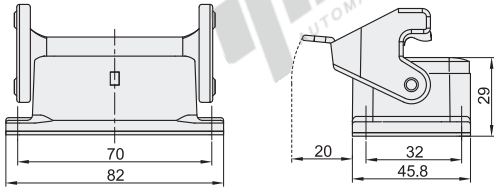

■ 面板开孔图

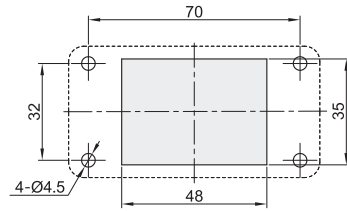

规格: 10B
锁扣方式: 单扣

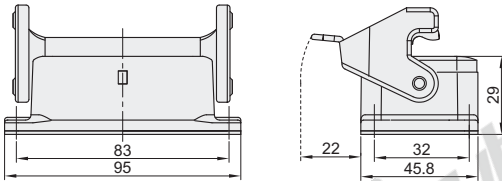

■ 面板开孔图

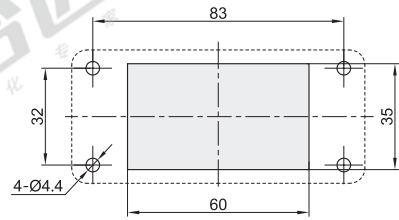

规格: 10B
锁扣方式: 双扣

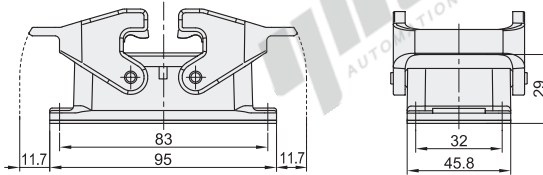

■ 面板开孔图

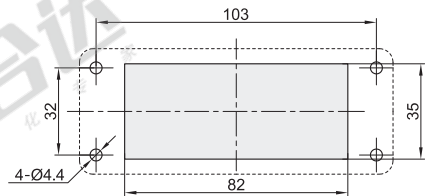

规格: 16B
锁扣方式: 单扣

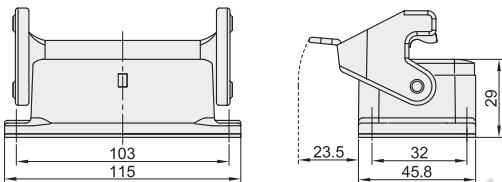

规格: 16B
锁扣方式: 双扣

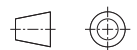
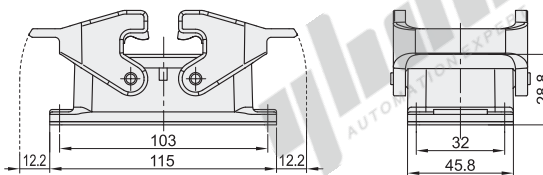

视角标准: 第一视角

规格: 24B
锁扣方式: 单扣

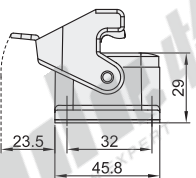
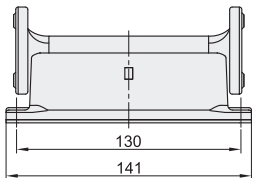

■ 面板开孔图

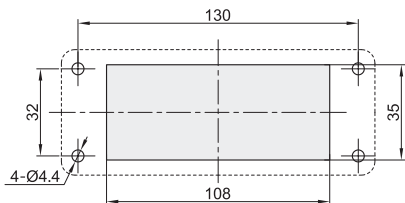

规格: 24B
锁扣方式: 双扣

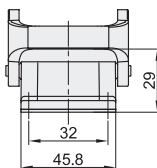
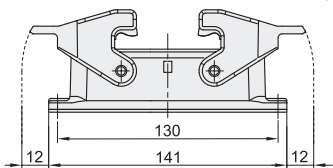

视角标准: 第一视角

型号		安装方式	锁扣方式	适配插芯	适配E型上壳
代码	外壳规格			E型常规型	
ZKW33	6B	BK(面板安装型)	1L (单扣)	ZKW31-06-M/ZKW31-06-F	ZKW34-6B-SE-2B/ZKW34-6B-TE-2B
	10B			ZKW31-10-M/ZKW31-10-F	ZKW34-10B-SE-2B/ZKW34-10B-TE-2B
	16B			ZKW31-16-M/ZKW31-16-F	ZKW34-16B-SE-2B/ZKW34-16B-TE-2B
	24B		2L (双扣)	ZKW31-24-M/ZKW31-24-F	ZKW34-24B-SE-2B/ZKW34-24B-TE-2B
	10B			ZKW31-10-M/ZKW31-10-F	ZKW34-10B-SE-4B/ZKW34-10B-TE-4B
	16B			ZKW31-16-M/ZKW31-16-F	ZKW34-16B-SE-4B/ZKW34-16B-TE-4B
24B	ZKW31-24-M/ZKW31-24-F	ZKW34-24B-SE-4B/ZKW34-24B-TE-4B			

① 适配插芯E型常规型详见P511, 适配E型上壳详见P515。



请按图示订货

型号		安装方式	锁扣方式
代码	外壳规格		
ZKW33	6B	BK(面板安装型)	1L (单扣)
	10B		

ZKW33-6B-BK-1L