

欧标20系列铝合金型材

槽宽6.2

代码	材质	表面处理
AOB02	A6063-T6	碱砂氧化
AOB03	A6063-T5	黑色氧化
AOB05		喷砂氧化

- ① 切断面未进行氧化处理。
- ② 最大使用长度：5800~5850mm；
整条标准长度：6000~6020mm。
- ③ 可定制表面处理。



□ L长度公差

□ 槽口详图

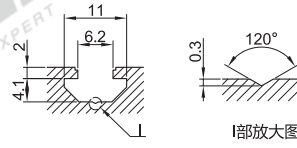
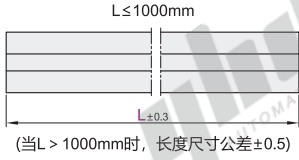

AOB02-H2020
AOB03-2020
AOB05-2020

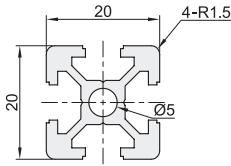

AOB03-2020A
AOB05-2020A

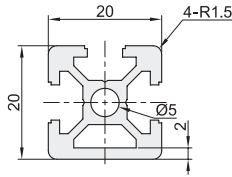

AOB03-2020B
AOB05-2020B

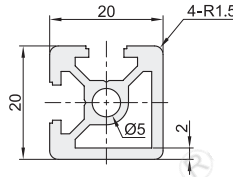

AOB05-2020C

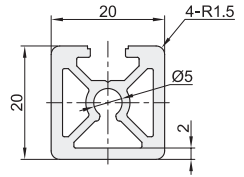

AOB02-H2040
AOB03-2040
AOB05-2040

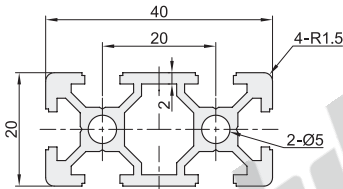

AOB05-2040A

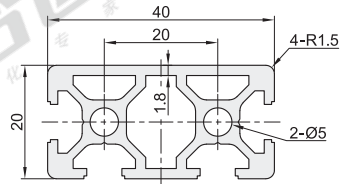

AOB05-2040H

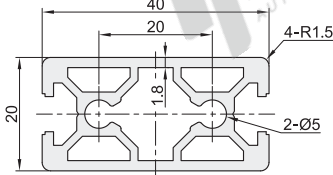

AOB05-2040C

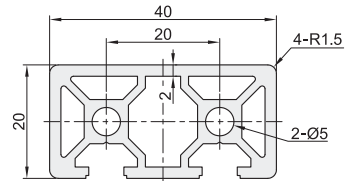

AOB02-H2060
AOB05-2060

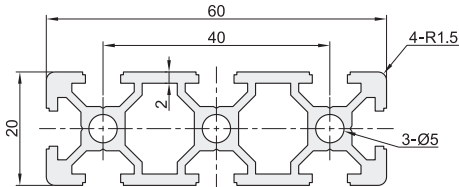

AOB02-H2080

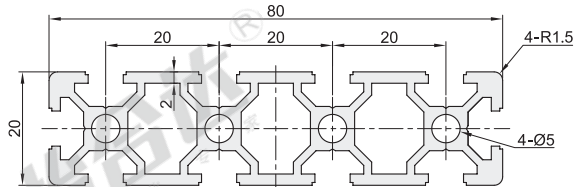

AOB05-2525

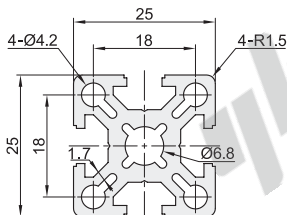

AOB05-2550

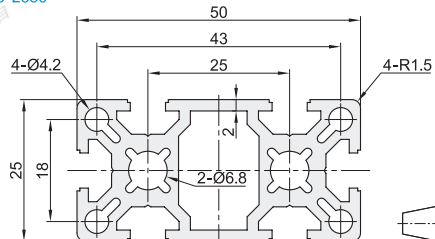

AOB02-H4420
AOB03-4420
AOB05-4420

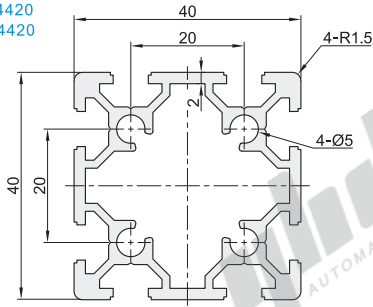

AOB05-4060S

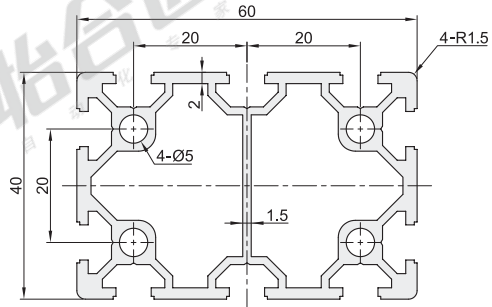

AOB05-4080S

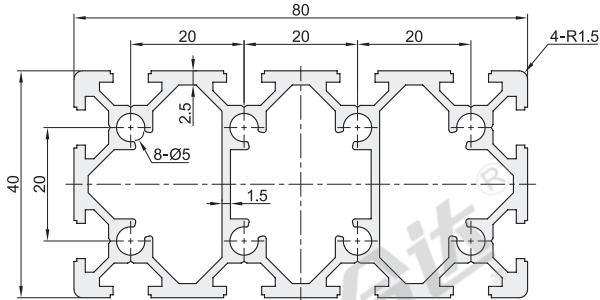

型号		L 最小单位0.5	截面尺寸	每米重量Kg/m (理论值)	截面积 (mm ²)	截面惯性矩		抗弯截面模数	
代码	规格					<i>I_x</i>	<i>I_y</i>	W _{xmax} (mm ³)	W _{ymax} (mm ³)
AOB02	H2020		20×20	0.48	172.64	0.73×10 ⁴	0.73×10 ⁴	728.80	728.80
	H2040		20×40	0.82	297.99	1.30×10 ⁴	4.90×10 ⁴	1296.50	2449.45
	H2060		20×60	1.17	423.34	1.86×10 ⁴	15.03×10 ⁴	1864.10	5009.57
	H2080		20×80	1.51	548.68	2.43×10 ⁴	33.63×10 ⁴	2431.85	8406.35
	H4420		40×40	1.19	432.19	8.29×10 ⁴	8.29×10 ⁴	4144.95	4144.95
AOB03	2020		20×20	0.48	172.64	0.73×10 ⁴	0.73×10 ⁴	728.80	728.80
	2020A		20×20	0.51	185.70	0.83×10 ⁴	0.73×10 ⁴	778.23	733.37
	2020B		20×20	0.51	185.09	0.80×10 ⁴	0.80×10 ⁴	777.64	777.64
	2040		20×40	0.82	297.99	1.30×10 ⁴	4.90×10 ⁴	1296.50	2449.45
	4420		40×40	1.19	432.19	8.29×10 ⁴	8.29×10 ⁴	4144.95	4144.95
AOB05	2020	50-6000	20×20	0.48	172.64	0.73×10 ⁴	0.73×10 ⁴	728.80	728.80
	2020A		20×20	0.51	185.70	0.83×10 ⁴	0.73×10 ⁴	778.23	733.37
	2020B		20×20	0.51	185.90	0.80×10 ⁴	0.80×10 ⁴	777.64	777.64
	2020C		20×20	0.55	199.21	0.82×10 ⁴	0.92×10 ⁴	782.86	923.03
	2040		20×40	0.82	297.99	1.30×10 ⁴	4.90×10 ⁴	1296.50	2449.45
	2040A		20×40	0.88	321.29	1.46×10 ⁴	5.09×10 ⁴	1367.85	2544.54
	2040H		20×40	0.91	330.12	1.66×10 ⁴	5.37×10 ⁴	1644.46	2644.62
	2040C		20×40	0.95	345.23	1.48×10 ⁴	5.97×10 ⁴	1393.06	2983.95
	4420		40×40	1.19	432.19	8.29×10 ⁴	8.29×10 ⁴	4144.95	4144.95
	2060		20×60	1.17	423.34	1.86×10 ⁴	15.03×10 ⁴	1864.10	5009.57
	4060S		40×60	1.68	611.22	11.71×10 ⁴	25.52×10 ⁴	5853.75	8507.80
	4080S		40×80	2.24	814.57	16.33×10 ⁴	54.53×10 ⁴	8164.30	13631.85
	2525		25×25	0.82	295.37	1.67×10 ⁴	1.67×10 ⁴	1334.88	1334.88
2550	25×50	1.38	501.11	3.10×10 ⁴	12.45×10 ⁴	2478.96	4981.16		



请按图示订货

型号		L 最小单位0.5	截面尺寸
代码	规格		
AOB05	2020B 2040	50<S<D00	20×20 20×40

☑ 可选加工

型号		L 最小单位0.5	可选加工 代码
代码	规格		
AOB05	2020B 2040	50<S<D00	LM RM DM

AOB05-2040-L350-RM



可选加工

☑ 端面螺孔加工

代码	技术说明
	变更通孔为螺孔
	选型方法 LM/RM/DM
	☑ Ø5通孔变更为螺孔M6深15.

☑ 可选加工见P603-608.