

# 带座轴承

## 立式座外球面球轴承

铸造型(轴承座凹球面公差: 过渡配合)

| 代码    | 类型  | 材质       |       |
|-------|-----|----------|-------|
|       |     | 轴承座      | 轴承    |
| E-BDJ | 经济型 | HT200灰铸铁 | GCr15 |
| BDJ   | 标准型 |          |       |

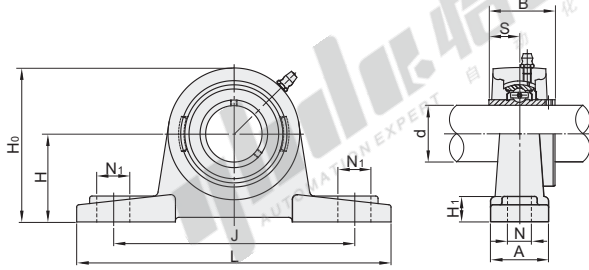

精度: JIS B 1558  
JIS B 1514  
JIS B 1559  
(GB/T 7809-1995)

视图标准: 第一视角

| 型号                |        | 国标型号   | d   | H     | L   | J   | A   | N  | N <sub>1</sub> | H <sub>1</sub> | H <sub>0</sub> | S    | B    | 安装孔尺寸(Δ)公差 | 安装孔位置度偏差x | 螺栓  | 紧定扭力(N·m) | 基本额定载荷(N) |        | 重量(g) |       |
|-------------------|--------|--------|-----|-------|-----|-----|-----|----|----------------|----------------|----------------|------|------|------------|-----------|-----|-----------|-----------|--------|-------|-------|
| 代码                | 规格     |        |     |       |     |     |     |    |                |                |                |      |      |            |           |     |           | 动(Cr)     | 静(Cor) |       |       |
| 经济型 E-BDJ         | 201    | UCP201 | 12  |       |     |     |     |    |                |                |                |      |      |            |           |     |           |           |        |       |       |
|                   | 202    | UCP202 | 15  | 30.2  | 127 | 95  |     |    | 19             | 15             | 62             | 12.7 | 31   |            |           |     |           | 12800     | 6650   | 630   |       |
|                   | 203    | UCP203 | 17  |       |     |     |     | 38 | 13             | 15             |                |      |      |            |           |     |           |           |        |       |       |
|                   | 204    | UCP204 | 20  | 33.3  |     |     |     |    |                |                | 65             |      |      |            | 0.6       | M10 | 17        |           |        | 650   |       |
|                   | 205    | UCP205 | 25  | 36.5  | 140 | 105 |     |    | 16             | 16             | 70             | 14.3 | 34   |            |           |     |           | 14000     | 7880   | 790   |       |
|                   | 206    | UCP206 | 30  | 42.9  | 165 | 121 |     | 48 |                | 21             | 18             | 83   | 15.9 | 38.1       | ±0.5      |     |           | 19500     | 11200  | 1300  |       |
|                   | 207    | UCP207 | 35  | 47.6  | 167 | 127 |     |    | 17             |                | 19             | 94   | 17.5 | 42.9       |           | 0.8 | M14       | 47        | 25700  | 15200 | 1600  |
|                   | 208    | UCP208 | 40  | 49.2  | 184 | 137 |     |    |                | 25             | 19             | 100  |      |            |           |     |           | 29600     | 18200  | 2000  |       |
|                   | 209    | UCP209 | 45  | 54    | 190 | 146 |     | 54 |                | 22             | 20             | 108  | 19   | 49.2       |           |     |           | 31850     | 20800  | 2200  |       |
|                   | 210    | UCP210 | 50  | 57.2  | 206 | 159 |     |    | 60             | 20             | 25             | 114  |      | 51.6       |           |     | M16       | 73        | 35100  | 23200 | 2800  |
| 经济型 E-BDJ 标准型 BDJ | 211    | UCP211 | 55  | 63.5  | 219 | 171 |     |    | 20             | 25             | 126            | 22   | 55.6 |            |           |     | M16       | 73        | 43300  | 29200 | 3400  |
|                   | 212    | UCP212 | 60  | 69.8  | 241 | 184 |     | 70 |                |                | 138            | 25.4 | 65.1 |            |           |     | M16       | 73        | 47750  | 32900 | 4800  |
|                   | 213    | UCP213 | 65  | 76.2  | 265 | 203 |     |    | 29             |                | 150            |      |      |            |           |     |           |           | 57200  | 40000 | 5700  |
|                   | 214    | UCP214 | 70  | 79.4  | 266 | 210 | 72  |    |                | 27             | 156            | 30.2 | 74.6 |            |           |     |           |           | 60800  | 45000 | 7000  |
|                   | 215    | UCP215 | 75  | 82.6  | 275 | 217 | 74  | 25 | 31             | 28             | 163            | 33.3 | 77.8 | ±0.8       | 0.8       | M20 | 145       | 66100     | 49400  | 7600  |       |
|                   | 216    | UCP216 | 80  | 88.9  | 292 | 232 | 78  |    |                | 30             | 175            | 82.6 |      |            |           |     |           |           | 71500  | 54000 | 9000  |
|                   | 217    | UCP217 | 85  | 95.2  | 310 | 247 | 83  |    |                | 32             | 187            | 84.1 | 85.7 |            |           |     |           |           | 83200  | 63900 | 11500 |
|                   | 218    | UCP218 | 90  | 101.6 | 327 | 262 | 88  | 27 | 33             | 34             | 200            | 39.7 | 96   |            |           |     | M22       | 200       | 95900  | 71400 | 14300 |
|                   | 305    | UCP305 | 25  | 45    | 175 | 132 | 45  |    |                | 16             | 85             | 15   | 38   |            | ±0.6      |     |           |           | 22300  | 11400 | 1600  |
|                   | 306    | UCP306 | 30  | 50    | 180 | 140 | 50  |    | 17             | 19             | 95             | 17   | 43   |            |           | M14 | 47        | 27000     | 15000  | 2100  |       |
|                   | 307    | UCP307 | 35  | 56    | 210 | 160 | 56  |    |                | 25             | 21             | 105  | 48   |            |           |     |           | 33000     | 19000  | 2800  |       |
|                   | 308    | UCP308 | 40  | 60    | 220 | 170 | 60  |    |                | 27             | 23             | 116  | 19   | 52         |           | 0.7 |           |           | 40500  | 24000 | 3600  |
|                   | 309    | UCP309 | 45  | 67    | 245 | 190 | 67  |    |                | 30             | 25             | 128  | 22   | 57         |           |     |           |           | 52800  | 31800 | 4700  |
|                   | 310    | UCP310 | 50  | 75    | 275 | 212 | 75  | 20 | 35             | 28             | 143            | 61   |      |            |           |     | M16       | 73        | 61800  | 37900 | 6400  |
|                   | 311    | UCP311 | 55  | 80    | 310 | 236 | 80  |    |                | 31             | 154            | 25   | 66   |            |           |     |           |           | 71500  | 44700 | 7800  |
|                   | 312    | UCP312 | 60  | 85    | 330 | 250 | 85  | 25 | 38             | 33             | 165            | 26   | 71   | ±0.8       |           | M20 | 145       | 81700     | 51800  | 9400  |       |
|                   | 313    | UCP313 | 65  | 90    | 340 | 260 |     |    |                | 36             | 174            | 30   | 75   |            |           |     |           |           | 93800  | 60000 | 10300 |
|                   | 314    | UCP314 | 70  | 95    | 360 | 280 |     | 90 |                |                | 186            | 33   | 78   |            |           |     |           |           | 104100 | 68000 | 11900 |
| 315               | UCP315 | 75     | 100 | 380   | 290 | 100 | 27  | 40 |                | 197            | 32             | 82   |      |            | M22       | 200 | 113400    | 77000     | 14500  |       |       |
| 316               | UCP316 | 80     | 106 | 400   | 300 |     |     |    |                | 209            | 34             | 86   |      |            |           |     |           | 122900    | 86500  | 17100 |       |
| 317               | UCP317 | 85     | 112 | 420   | 320 | 110 |     |    | 45             | 221            | 40             | 96   |      |            | 1         | M27 | 372       | 132500    | 96500  | 19200 |       |
| 318               | UCP318 | 90     | 118 | 430   | 330 |     | 33  | 45 |                | 233            |                |      |      |            |           |     |           | 144050    | 108000 | 21100 |       |
| 319               | UCP319 | 95     | 125 | 470   | 360 |     |     |    | 50             | 250            | 41             | 103  |      |            |           |     |           | 156600    | 122000 | 28200 |       |
| 320               | UCP320 | 100    | 140 | 490   | 380 |     | 120 | 36 | 50             | 55             | 275            | 42   | 108  |            |           | M30 | 500       | 173000    | 140000 | 34800 |       |
| 322               | UCP322 | 110    | 150 | 520   | 400 |     |     |    |                | 60             | 295            | 46   | 117  |            |           |     |           | 204900    | 178300 | 43200 |       |
| 324               | UCP324 | 120    | 160 | 570   | 450 |     |     |    |                | 70             | 321            | 51   | 126  | ±1         |           |     |           | 227500    | 207000 | 54000 |       |
| 326               | UCP326 | 130    | 180 | 600   | 480 |     | 140 | 40 | 55             |                | 354            | 54   | 135  |            |           | M33 | 690       | 253000    | 241000 | 72100 |       |
| 328               | UCP328 | 140    | 200 | 620   | 500 |     |     |    |                | 388            | 59             | 145  |      |            |           |     |           | 274500    | 270000 | 91200 |       |

带座轴承 E6



| 型号    |     | 国标型号   |
|-------|-----|--------|
| 代码    | 规格  |        |
| E-BDJ | 201 | UCP201 |
|       | 202 | UCP202 |

E-BDJ-201



| 优惠价 |      |      |
|-----|------|------|
| 数量  | 1~9  | 10~  |
| 价格  | 100% | 另行报价 |



| 交货期 |
|-----|
| 7   |



带座轴承支撑旋转, 关节轴承作连接件, 实现曲柄摇杆运动, 用于升降零部件, 阻挡工件。主要用于智能仓储行业。

