

欧标40槽宽8.2系列铝合金型材

◀ 边长40/60mm

代码	材质	表面处理
AOB03		黑色氧化
AOB05	A6063-T5	喷砂氧化
AMS05		喷砂氧化

- ① 切断面未进行氧化处理。
- ② 最大使用长度：5800~5850mm；
整条标准长度：6000~6020mm。
- ③ 可定制表面处理。

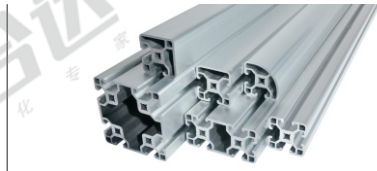

☑ L长度公差

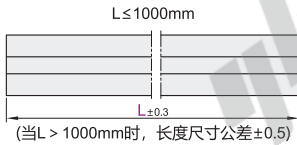

☑ 槽口详图

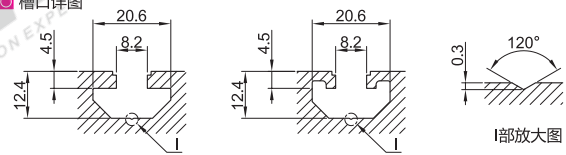

AOB05-4040

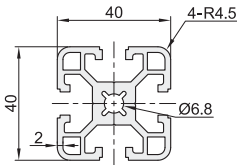

AOB05-4040C

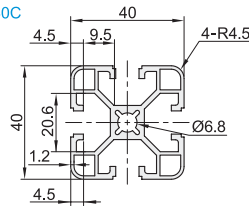

AOB03-4040E
AOB05-4040E

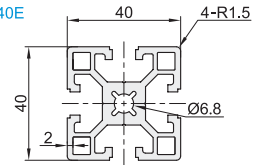

AOB05-4040F

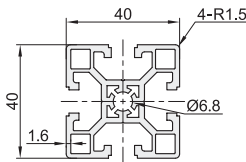

AOB03-4040J
AOB05-4040J

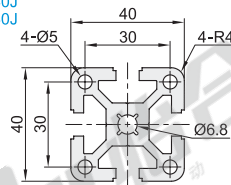

AOB05-4040A

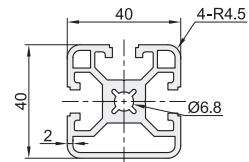

AOB05-4040B

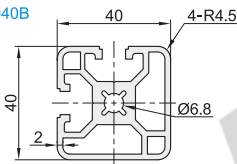

AOB05-4040H

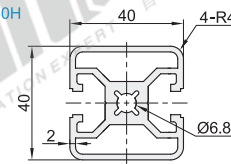

AOB05-4040T

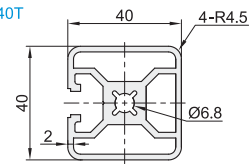

AOB05-4040R

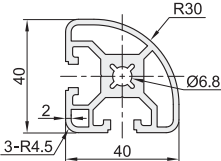

AOB03-4040RE
AOB05-4040RE

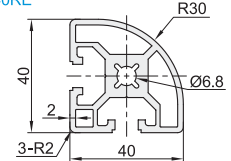

AOB05-4040XE

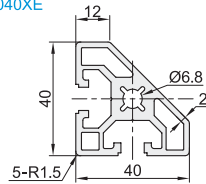

AOB05-4430

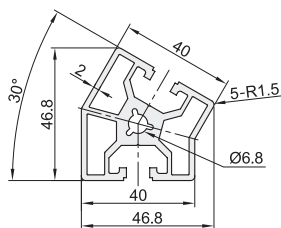

AOB05-4445

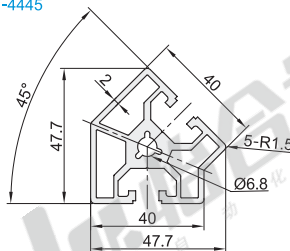

AOB05-4460

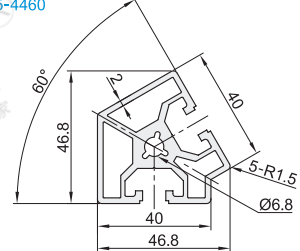

AMS05-OB40-E

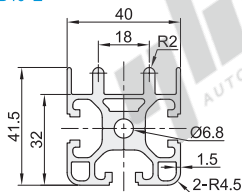

AOB05-4080

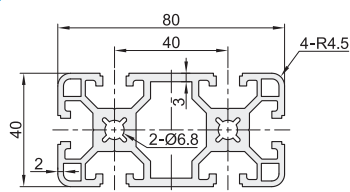

槽宽8.2系列
欧标40

AOB05-4080C

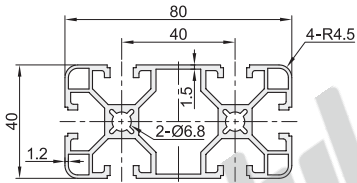

AOB03-4080E
AOB05-4080E

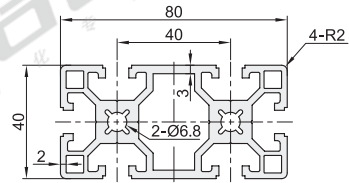

AOB05-4080F

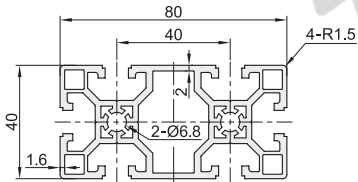

AOB03-4080J
AOB05-4080J

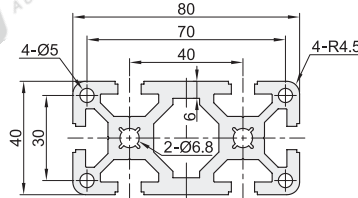

AOB05-4080A

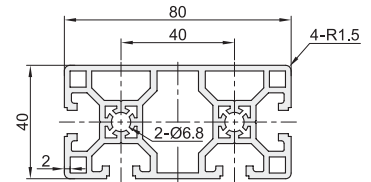

AOB05-4080FA

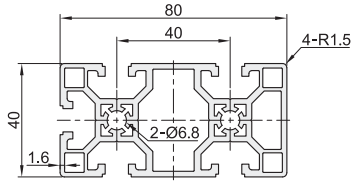

AOB05-4080B

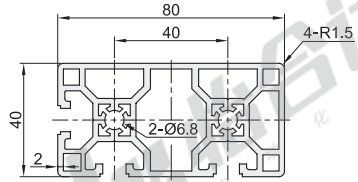

AOB05-4080H

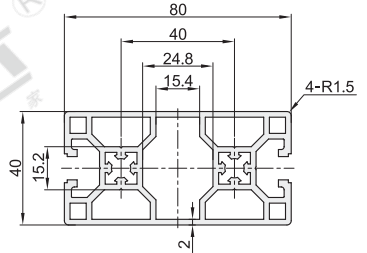

AOB05-40120E

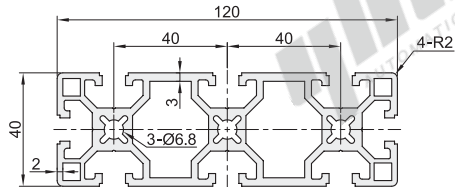

AOB05-40160

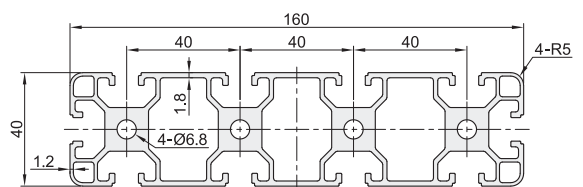

AOB05-40160E

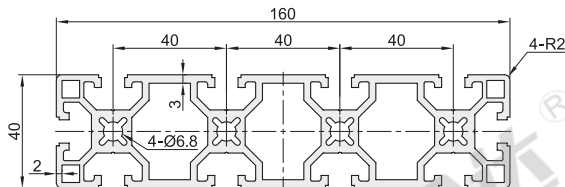

AOB05-40200E

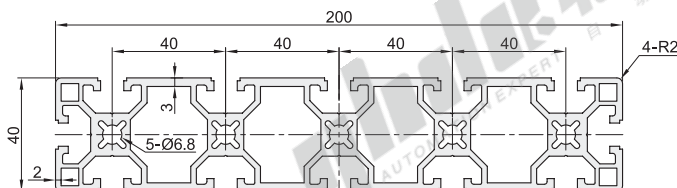

AOB05-8840

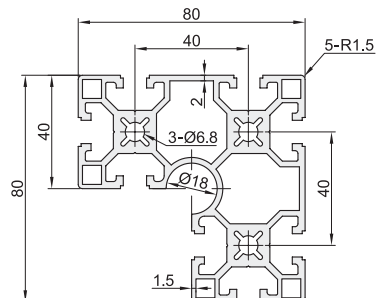

AOB05-8840R

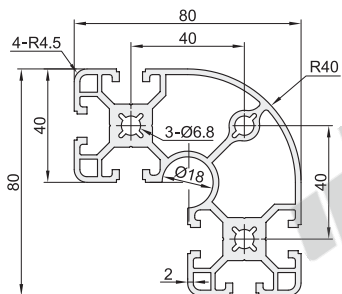

AOB05-8840RE

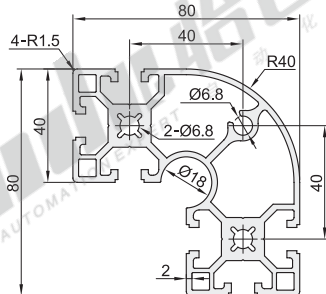

AOB05-8840RF

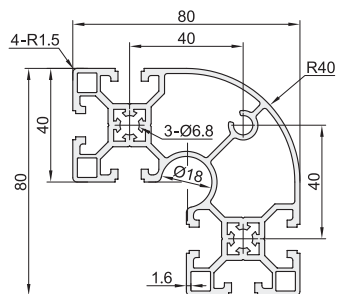

AOB05-8080

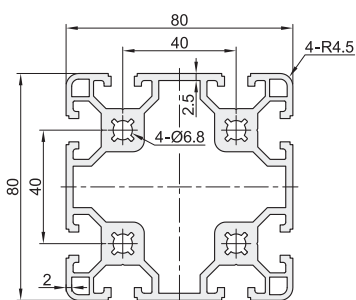

AOB05-8080A

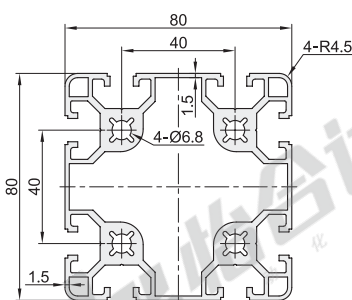

AOB03-8080E
AOB05-8080E

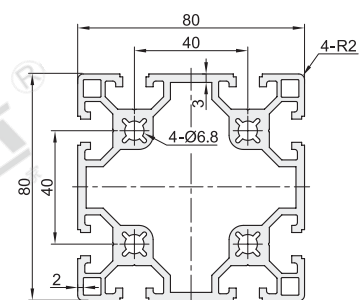

AOB05-8080F

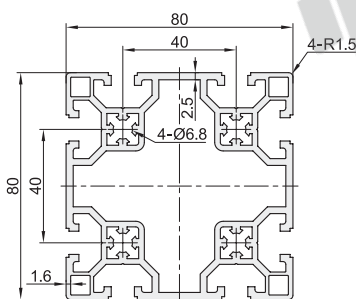

AOB05-8080FA

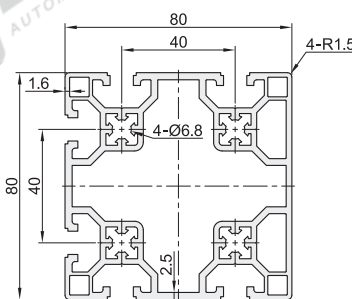

AOB05-8080J

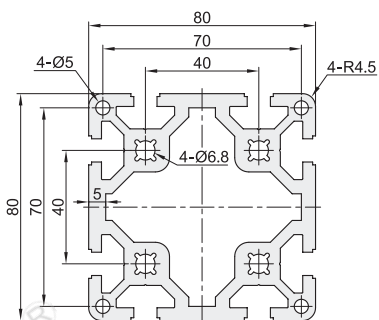

AOB05-8080XE

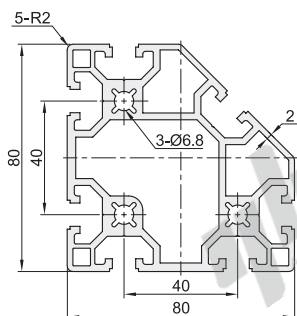

AOB05-80120E

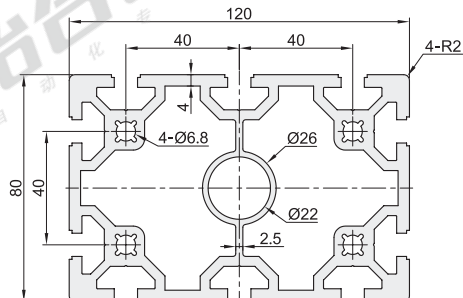

槽宽
8.2系列
欧标
40

AOB05-80160E

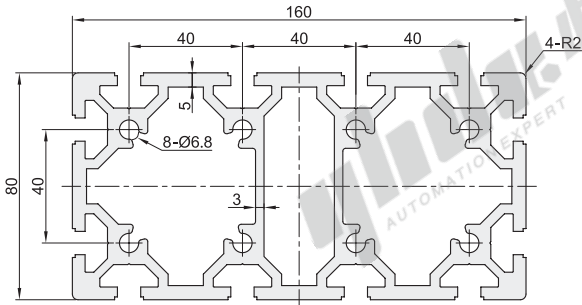

AOB05-120120E

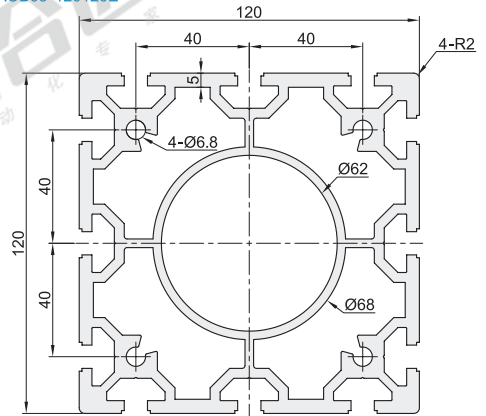

AOB05-120120G

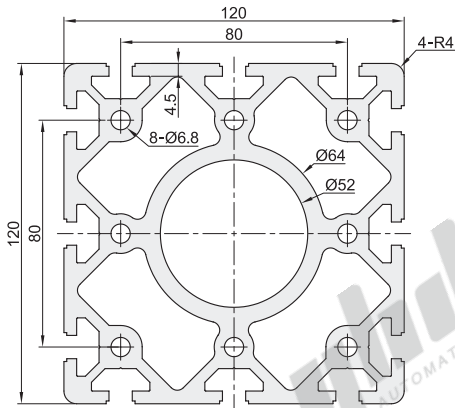

AOB05-160160E

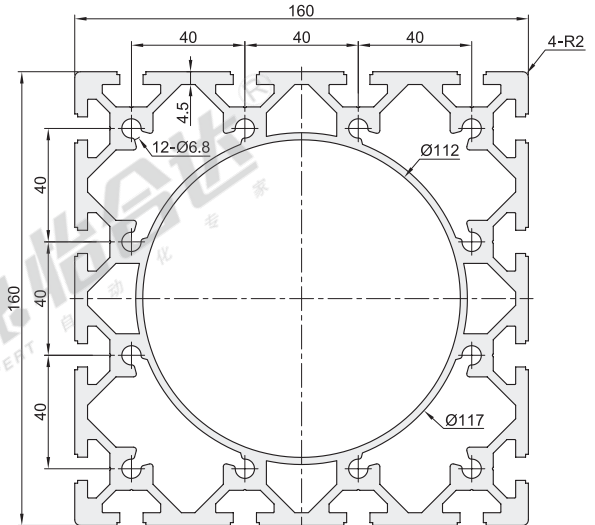

AOB05-200200E

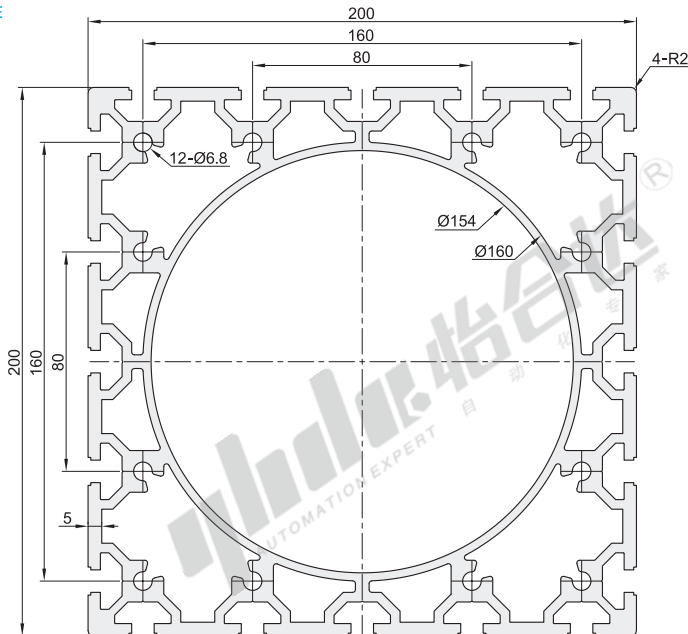

欧标40槽宽8.2系列铝合金型材

◀ 边长200mm

AOB05-80200E

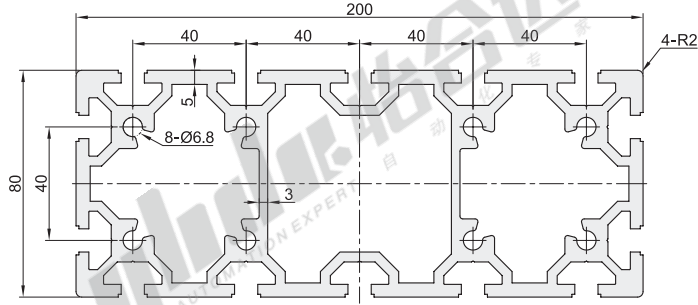

型号		L 最小单位0.5	截面尺寸	每米重量Kg/m (理论值)	截面积 (mm ²)	截面惯性矩		抗弯截面模数	
代码	规格					<i>I_x</i>	<i>I_y</i>	W _{xmax} (mm ³)	W _{ymax} (mm ³)
AOB03	4040E		40×40	1.68	608.10	9.22×10 ⁴	9.22×10 ⁴	4609.80	4609.80
	4040J			2.06	747.69	11.47×10 ⁴	11.47×10 ⁴	5733.10	5733.10
	4040RE		1.50	543.40	7.24×10 ⁴	7.24×10 ⁴	3360.99	3360.99	
	4080E		3.01	1094.38	17.79×10 ⁴	66.91×10 ⁴	8893.20	16727.53	
	4080J		4.01	1457.63	23.85×10 ⁴	83.36×10 ⁴	11922.55	20838.83	
	8080E		4.52	1642.72	119.09×10 ⁴	119.09×10 ⁴	29771.48	29771.48	
AOB05	4040	50~6000	40×40	1.65	597.70	8.82×10 ⁴	8.82×10 ⁴	4411.05	4411.05
	4040C			1.19	432.73	6.67×10 ⁴	6.67×10 ⁴	3333.30	3333.30
	4040E			1.68	608.10	9.22×10 ⁴	9.22×10 ⁴	4609.80	4609.80
	4040F			1.48	535.91	8.28×10 ⁴	8.28×10 ⁴	4139.80	4139.80
	4040J			2.06	747.69	11.47×10 ⁴	11.47×10 ⁴	5733.10	5733.10
	4040A			1.62	588.53	8.70×10 ⁴	8.70×10 ⁴	4305.22	4349.35
	4040B			1.64	596.60	8.87×10 ⁴	8.87×10 ⁴	4395.26	4395.26
	4040H			1.60	579.36	8.58×10 ⁴	8.58×10 ⁴	4288.16	4288.16
	4040T			1.60	581.18	8.52×10 ⁴	8.76×10 ⁴	4261.69	4354.76
	4430			1.66	604.06	8.70×10 ⁴	9.17×10 ⁴	3233.92	3492.17
	4445			1.66	603.12	8.75×10 ⁴	9.14×10 ⁴	3126.54	3406.69
	4460			1.67	604.57	8.83×10 ⁴	9.14×10 ⁴	3239.80	3527.88
	4040R		1.50	544.45	7.14×10 ⁴	7.14×10 ⁴	3323.41	3320.92	
	4040RE		1.50	543.40	7.24×10 ⁴	7.24×10 ⁴	3360.99	3360.99	
	4040XE		1.41	512.62	6.41×10 ⁴	6.41×10 ⁴	2832.74	2832.74	
	4080		2.99	1085.80	17.45×10 ⁴	65.52×10 ⁴	8722.75	16380.50	
	4080C		2.09	760.52	12.80×10 ⁴	47.98×10 ⁴	6399.25	11993.75	
	4080E		3.01	1094.38	17.79×10 ⁴	66.91×10 ⁴	8893.20	16727.53	
	4080F		2.64	959.18	15.94×10 ⁴	59.55×10 ⁴	7970.60	14887.15	
	4080J		4.01	1457.63	23.85×10 ⁴	83.36×10 ⁴	11922.55	20838.83	
	4080A		2.70	980.91	17.28×10 ⁴	65.80×10 ⁴	8579.05	16450.77	
	4080FA		2.65	960.95	15.89×10 ⁴	60.08×10 ⁴	7944.73	15019.74	
	4080B		2.71	982.65	17.22×10 ⁴	66.33×10 ⁴	8553.20	16539.01	
	4080H		2.71	984.38	17.65×10 ⁴	65.837×10 ⁴	8825.69	16459.29	
	8840		4.00	1453.23	82.20×10 ⁴	82.20×10 ⁴	17810.51	17810.51	
	8840R		3.50	1273.25	72.07×10 ⁴	72.07×10 ⁴	16722.25	16772.25	
	8840RE		3.57	1298.44	74.69×10 ⁴	74.69×10 ⁴	17466.95	17466.95	
	8840RF		3.10	1126.28	65.85×10 ⁴	66.08×10 ⁴	15397.37	15452.46	
	8080		4.75	1727.15	119.20×10 ⁴	119.19×10 ⁴	29799.03	29798.58	
	8080A		4.08	1482.51	102.13×10 ⁴	102.13×10 ⁴	25532.05	25532.05	
	8080E		4.52	1642.72	119.09×10 ⁴	119.09×10 ⁴	29771.48	29771.48	
	8080F		4.16	1511.46	108.20×10 ⁴	108.19×10 ⁴	27047.68	27047.68	
	8080FA		4.15	1507.71	108.21×10 ⁴	108.21×10 ⁴	27053.94	27053.23	
	8080J		6.35	2306.57	159.74×10 ⁴	159.98×10 ⁴	39934.13	39934.13	
	8080XE		4.18	1520.24	94.14×10 ⁴	94.14×10 ⁴	21222.00	21222.00	
	40120E		4.15	1508.71	26.32×10 ⁴	206.40×10 ⁴	13157.97	34399.97	
	40160		4.87	1769.62	26.20×10 ⁴	411.52×10 ⁴	13098.94	51440.23	
	40160E		5.41	1965.01	34.90×10 ⁴	467.82×10 ⁴	17451.65	58477.78	
	40200E		6.36	2312.88	42.35×10 ⁴	863.63×10 ⁴	21173.95	86363.44	
	80120E		7.89	2863.59	223.44×10 ⁴	467.28×10 ⁴	55859.83	77880.10	
	80160E		10.29	3739.33	303.04×10 ⁴	1004.90×10 ⁴	75759.18	125611.98	
	80200E		12.07	4389.65	396.23×10 ⁴	1877.10×10 ⁴	92306.33	187710.33	
	120120E		11.03	4011.31	677.34×10 ⁴	677.34×10 ⁴	112889.20	112889.20	
	120120G		14.23	5174.84	762.41×10 ⁴	762.41×10 ⁴	127068.48	127068.48	
160160E	16.08	5846.12	1870.81×10 ⁴	1870.81×10 ⁴	233851.01	233851.01			
200200E	21.72	7896.30	4058.42×10 ⁴	4058.42×10 ⁴	405842.00	405842.00			
AMS05	OB40-E	40×41.5	1.67	605.88	8.35×10 ⁴	8.29×10 ⁴	4105.00	4145.01	

槽宽8.2系列
欧标40

☑ 可选加工

型号	L	截面尺寸
代码 规格	最小单位0.5	40×40
AOB03 4040E	50<D00	40×40
4040RE		

请按照图示订货 AOB03—4040E—L550

☑ 可选加工

型号	L	可加工代码
代码 规格	最小单位0.5	LM RM DM
AOB03 4040E	50<D00	LM RM DM
4040RE		

AOB03—4040E—L550—RM

☑ 端面螺孔加工

代码	技术说明
	变更通孔为螺孔
	选型方法 LM/RM/DM
LM(左端面)	
RM(右端面)	
DM(双端面)	

☑ Ø6.8通孔变更为螺孔M8深20.

☑ 可选加工见P603-608.