

# 快速接线端子

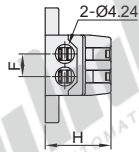

代码	类型	安装方式
ZMB81	快速接线端子	按压接线型 面板安装

极数: 2

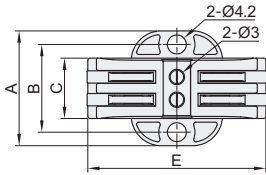

极数: 3

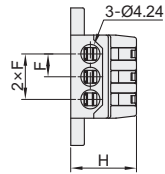
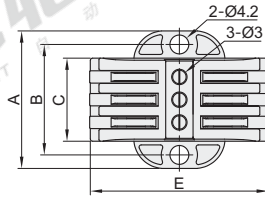

极数: 4

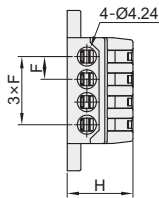
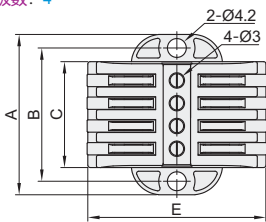

极数: 5

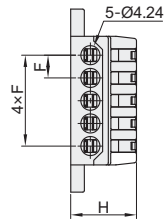
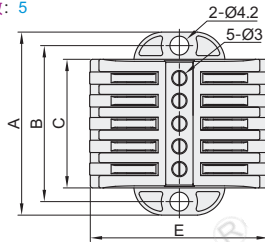

极数: 6

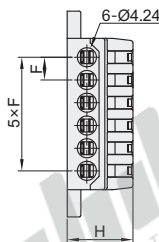
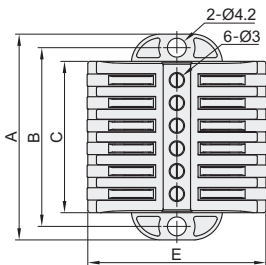

极数: 8

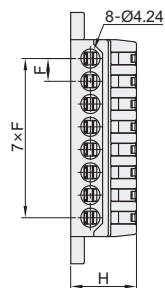
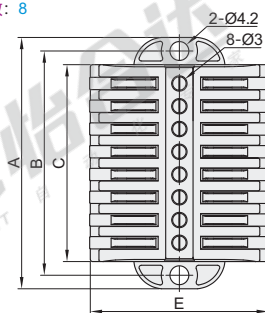

极数: 10

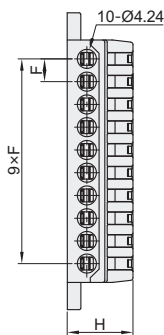
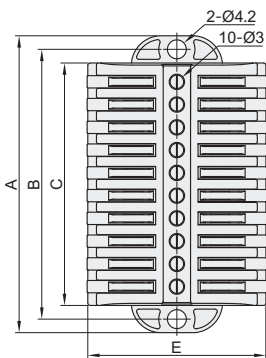

极数: 12

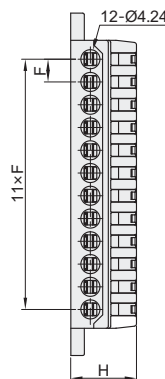
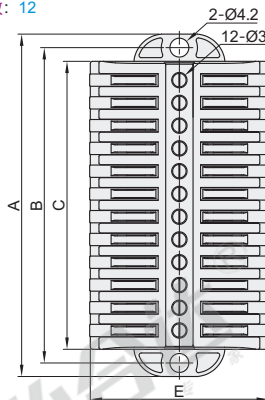

销售方式	每袋数量
袋	10PCS

视角标准: 第一视角

代码	型号	极数	A	B	C	E	F	H	额定电流 (A)	额定电压 (V)	导线线径 (mm <sup>2</sup> )	销售方式
ZMB81		2	25.3	19.3	13.3	39.3	5	14.5	32	250	0.5~4	袋 (10pcs/袋)
		3	30.3	24.3	18.3							
		4	35.3	29.3	23.3							
		5	40.3	34.3	28.3							
		6	45.3	39.3	33.3							
		8	55.3	49.3	43.3							
		10	65.3	59.3	53.3							
		12	75.3	69.3	63.3							



请按图示订货

型号	代码	极数	A
ZMB81	2	2	25.3
	3	3	30.3

ZMB81-2

接线端子