

StyleView Sit Stand Combo Arm

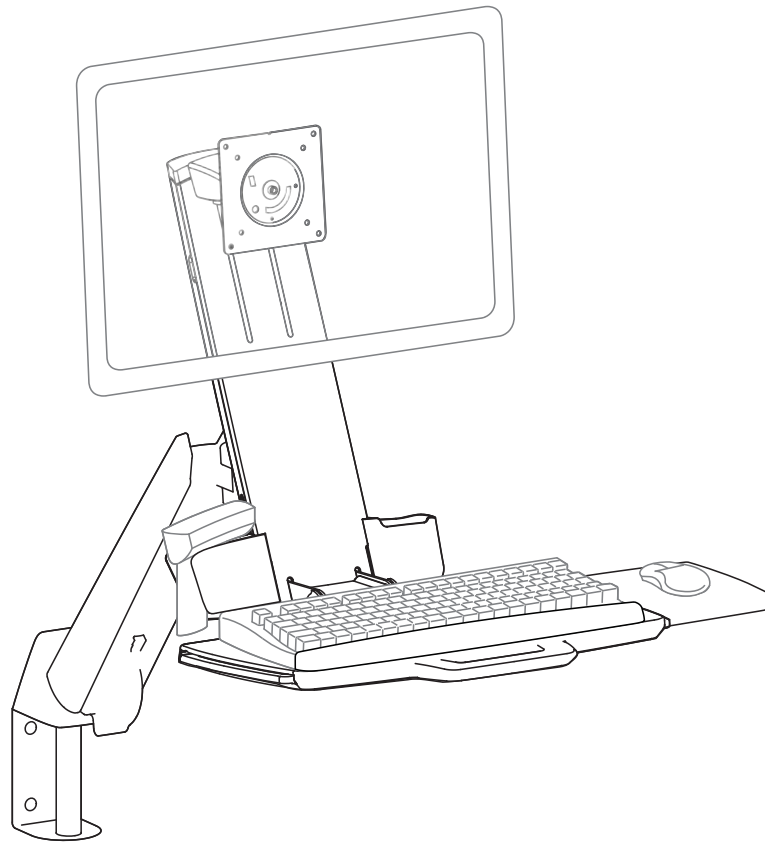

汉语

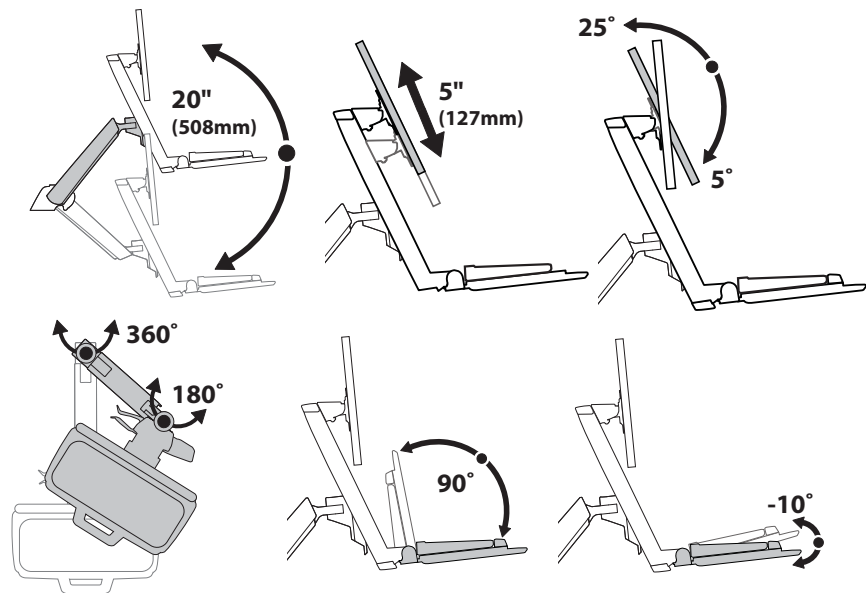
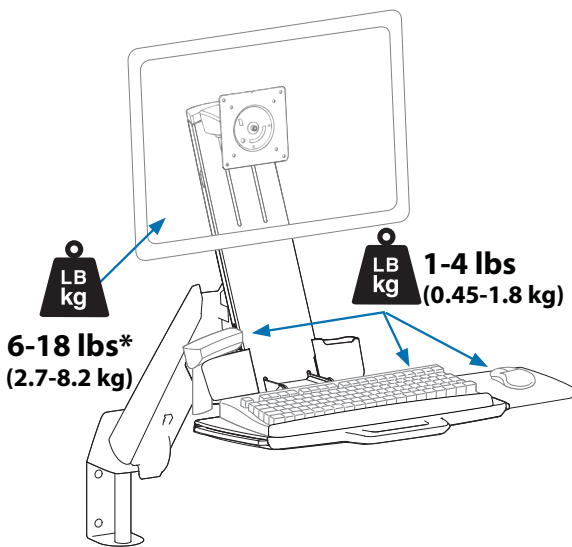

* Combo 支臂可在修改后安装重达 11.3 千克 (25 磅) 的显示器, 但是, 若选择此选项, 则无法进行显示器升降动作。请参阅第 8 页中的特别说明。

若需最新的用户安装指南, 请访问: www.ergotron.com



User's Guide - English
 Guía del usuario - Español
 Manuel de l'utilisateur - Français
 Gebrauchersgids - Deutsch
 Benutzerhandbuch - Nederlands
 Guida per l'utente - Italiano
 Användarhandbok - svenska
 ユーザーガイド: 日本語
 用户指南: 汉语

 www.ergotron.com
 USA 1-800-888-8458
 Europe +31 (0)33-45 45 600
 China 86-769-86018920



重要说明！本产品安装完成后需要调节。在尝试进行调节之前，确保所有设备都正确安装在产品上。本产品应能在整个动作范围内灵活自如地移动，并能固定在所设定的位置。如果移动过于容易或过于困难，或者产品不能固定在想要的位置上，请按照调节说明操作，使动作灵活自如。根据您所用产品及调节方式，可能需要旋转几圈后才能注意到差别。每次添加或者从本产品上拆除设备时，都会使安装负荷重量发生变化，您应该重复调节步骤，确保运行状态安全、最佳。

部件

	A	B	C	D
1				
2				
3				
4			选配的可承重量更改紧固件	

需要的工具

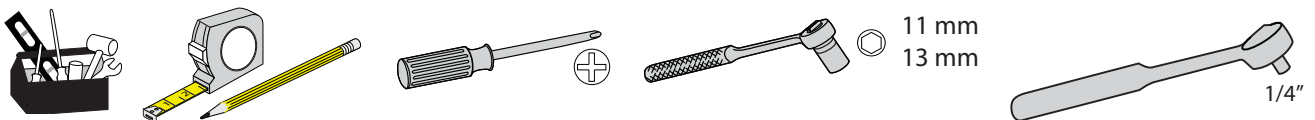

1 人体工程学工作站的安装高度

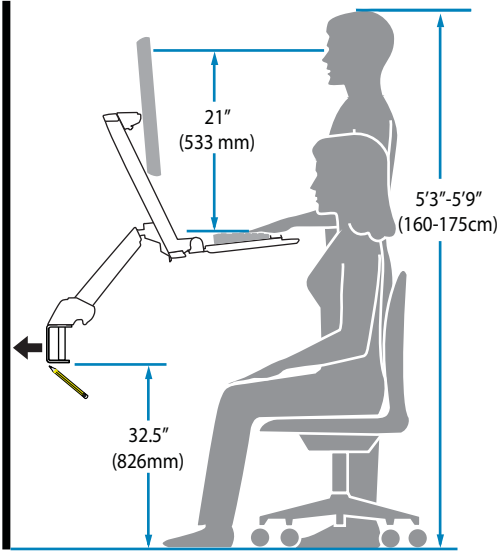

这个安装高度是适应身高为 5'3"-5'9" (160-175cm) 的用户的人体工程学工作站的推荐安装高度。

如果用户身高在此范围以外，您应更改安装高度以适应用户身高。（用户身高每相差一英寸则安装高度更改一英寸）。

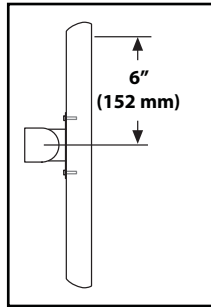

安装高度假设您的显示器安装孔中心与屏幕顶部之间的距离为 6" (152 mm)。如果您的距离更小，您应相应增加安装高度，如果您的距离更大，您应相应降低您的安装高度。

墙轨应用

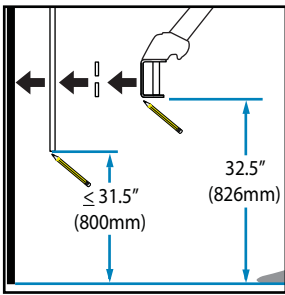

确定安装位置：

将支臂向后推靠墙的正视图。

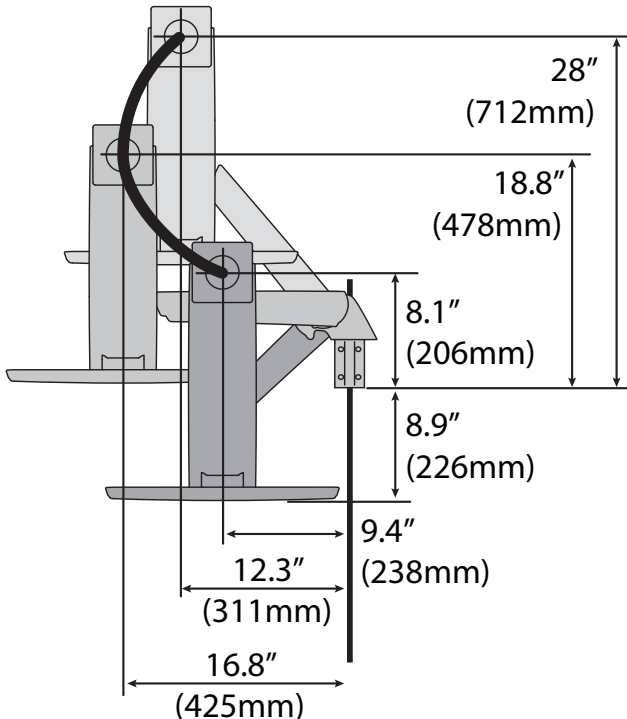

显示从墙壁拉出时运动范围的俯视图。

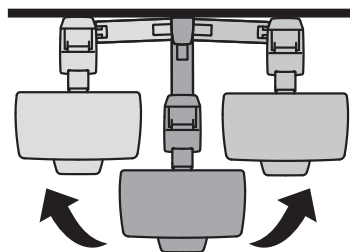

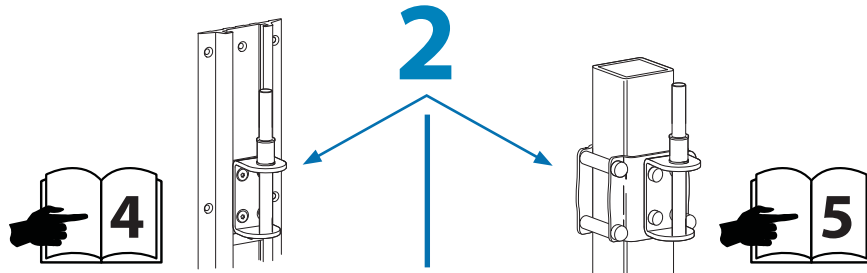

2

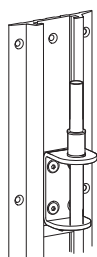

注: 長期間にわたり部品を取り付けたり、外したりしていると、その振動でファスナーが緩んでくることがあります。定期的に取り付け部品を点検し、緩んでいるファスナーがないかどうかを確認してください。ファスナーの緩みを防止するために、適宜、取り付けの前にネジ山を固定する市販の接着剤を使用してもよいでしょう。

a

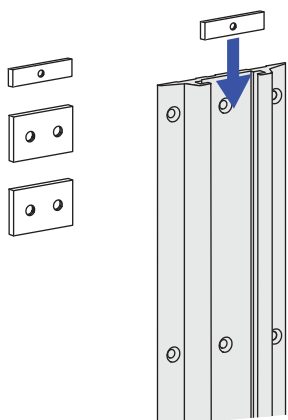

b

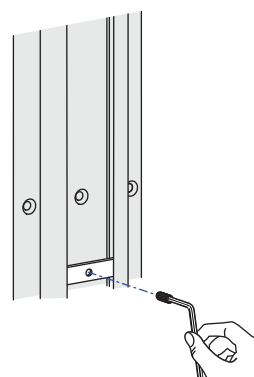
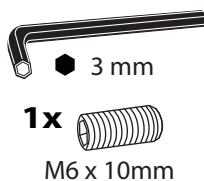

c

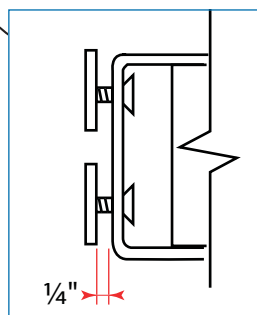
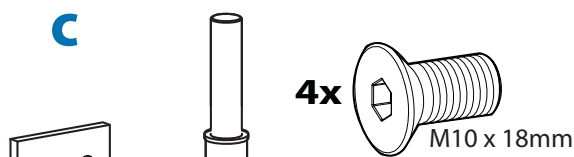

d

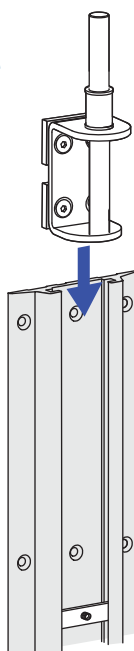

e

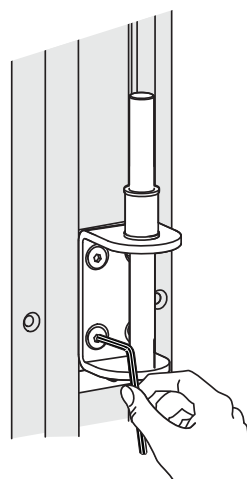

2

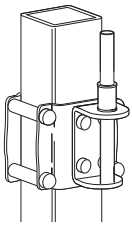

注: 長期間にわたり部品を取り付けたり、外したりしていると、その振動でファスナーが緩んでくる場合があります。定期的に取り付け部品を点検し、緩んでいるファスナーがないかどうかを確認してください。ファスナーの緩みを防止するために、適宜、取り付けの前にネジ山を固定する市販の接着剤を使用してもよいでしょう。

a

4x

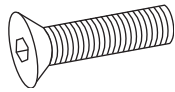

3/8-16 x 3/4"

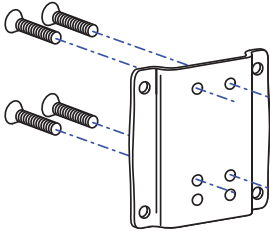

b

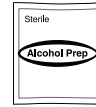
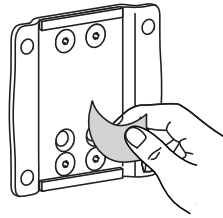

4x

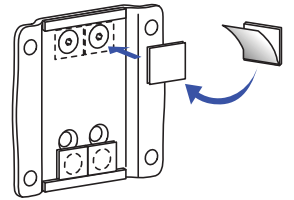
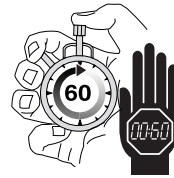

c

4x

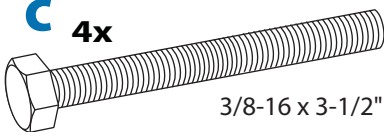

3/8-16 x 3-1/2"

4x



4x

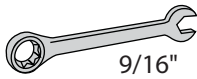

9/16"



4x



3/8" nylock nut

d

4x



3/8" lug nut

4x

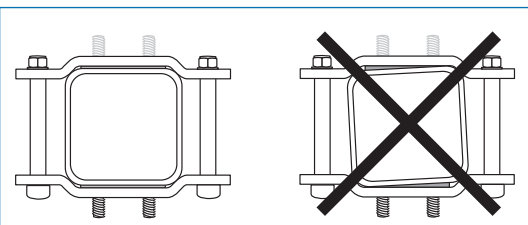
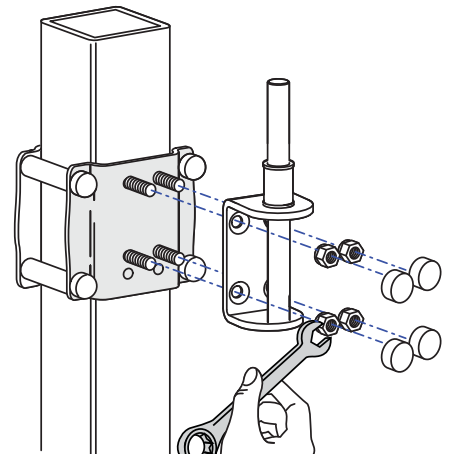
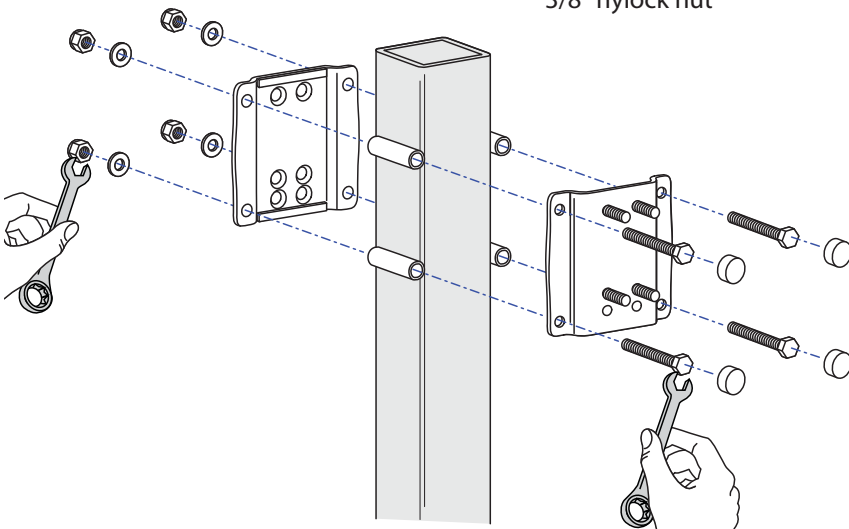
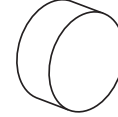

3

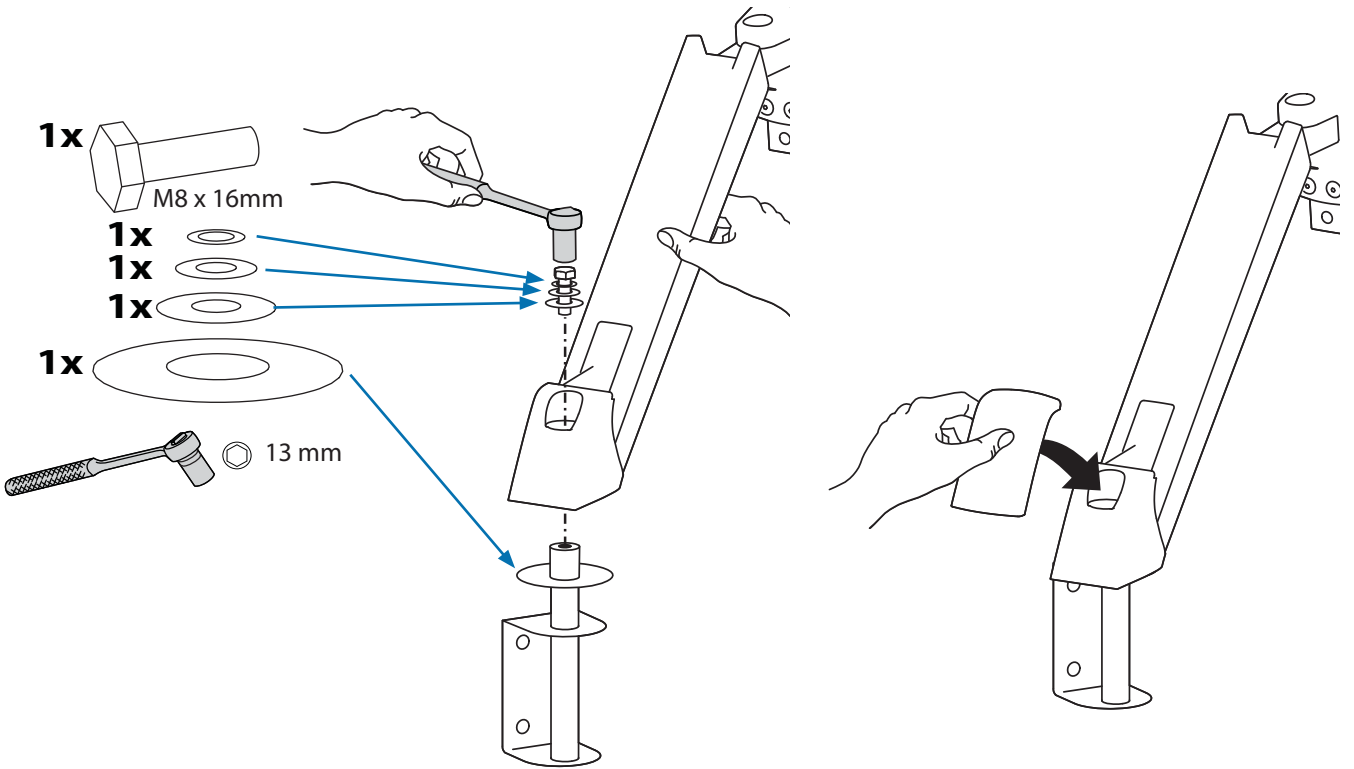

4

- 2x M5 x 15mm
- 3 mm

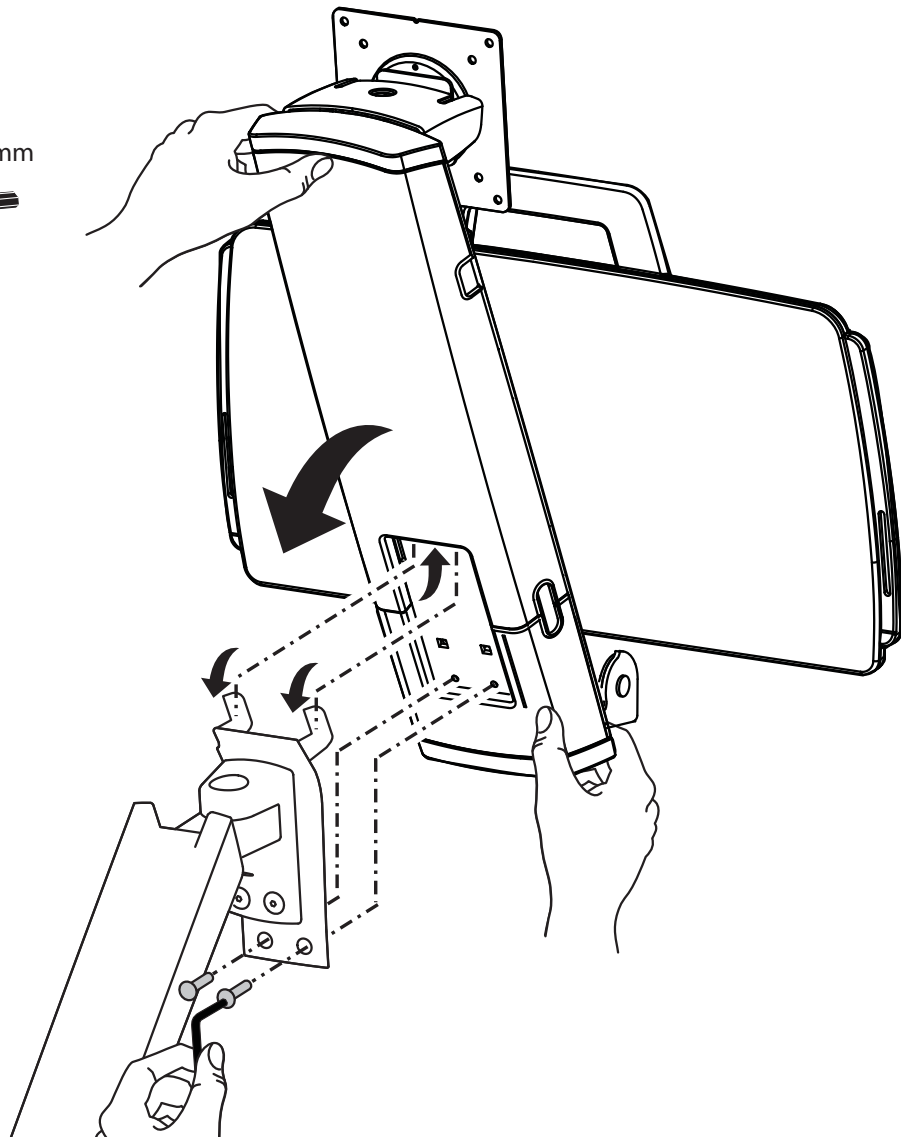

5 a

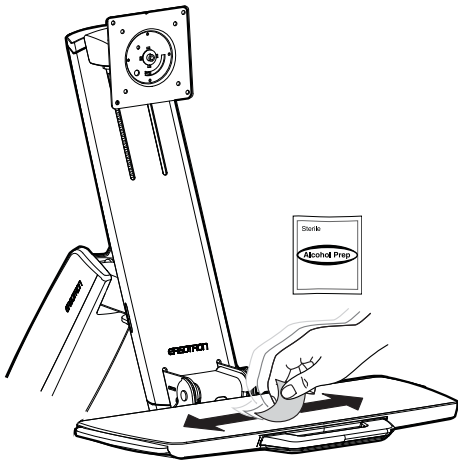

b

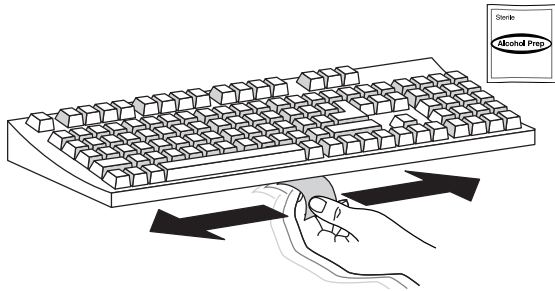

c

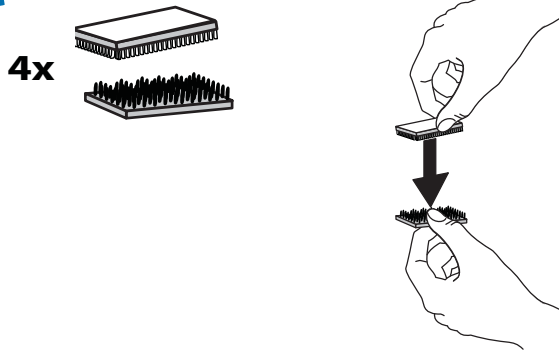

d

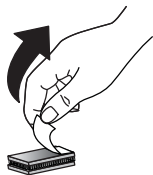

e

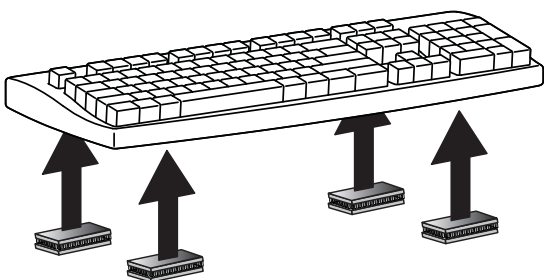

f

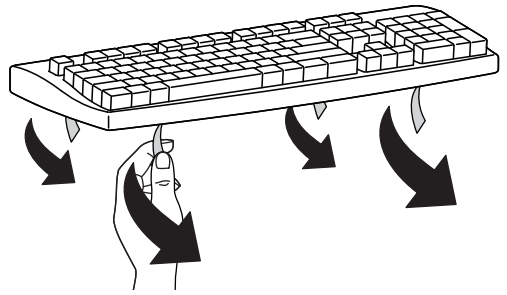

g

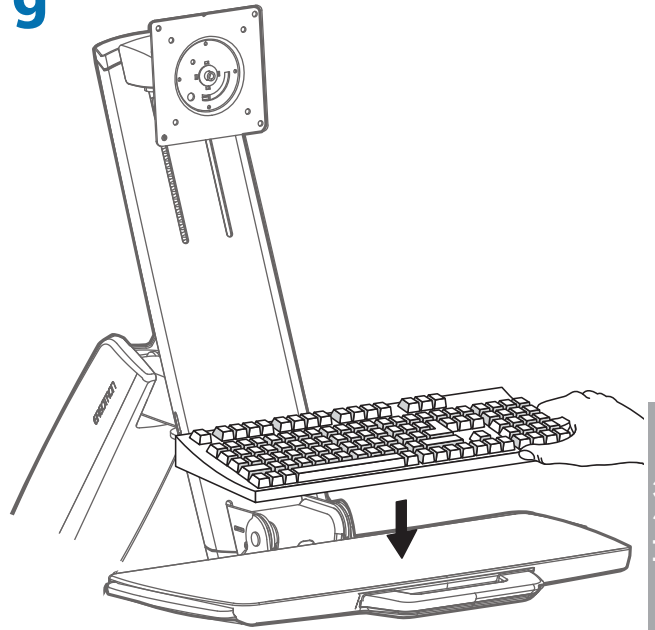

h

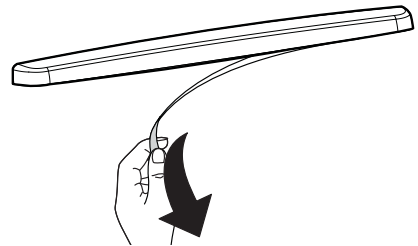

i

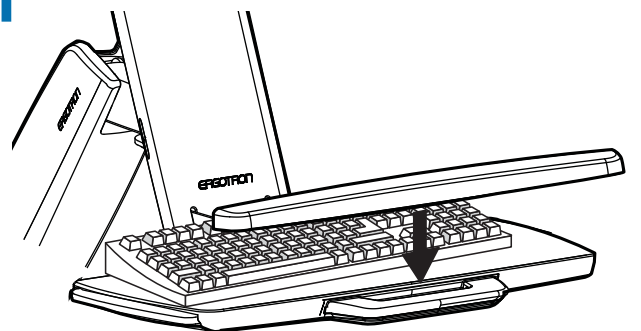

汉语

选配的可承重量更改

可选的可承重量更改方案，仅对 8.2 - 11.3 千克（18 - 25 磅）显示器适用！

重要说明：采用此选项，显示器无法再进行升降操作。为了承受额外的重量，显示器固定在三个高度中的一个（分布间隔 64 毫米（2.5 英寸），并且在 20° 倾角固定。如果所安装的显示器重量为 8.2 千克（18 磅）或以下，则跳到下一页。

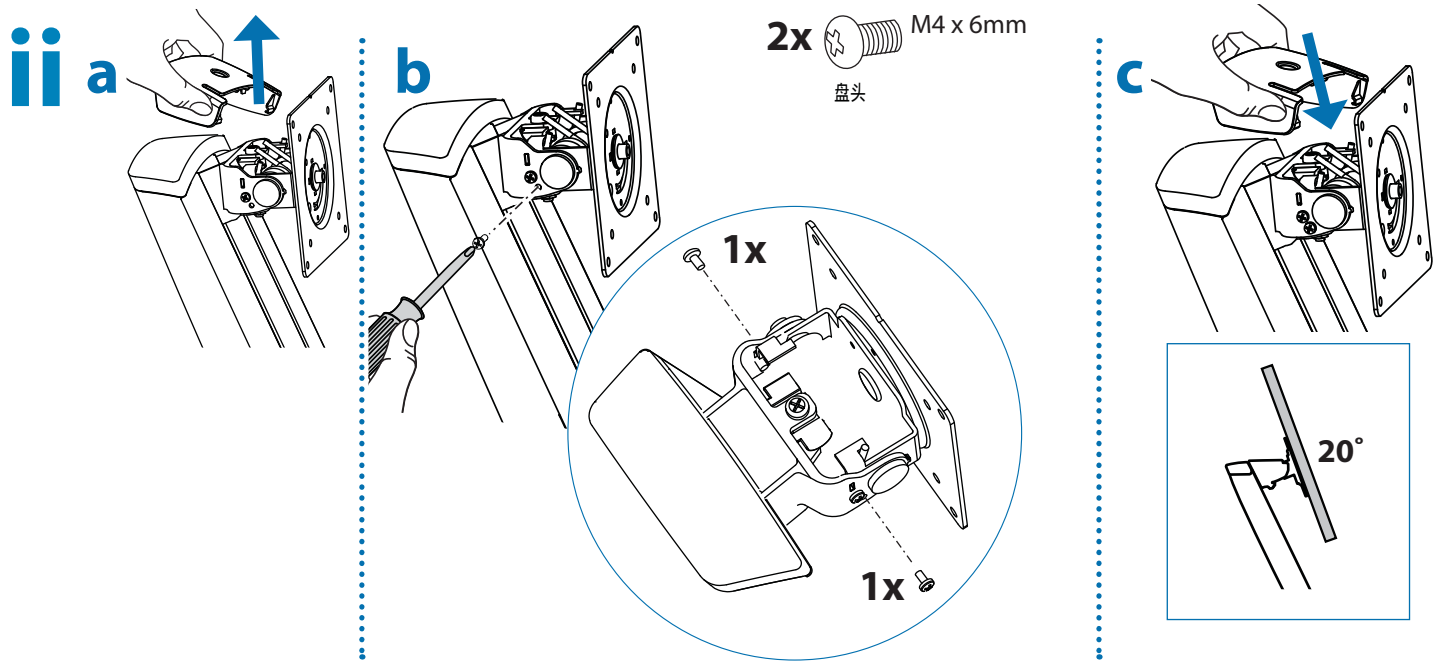
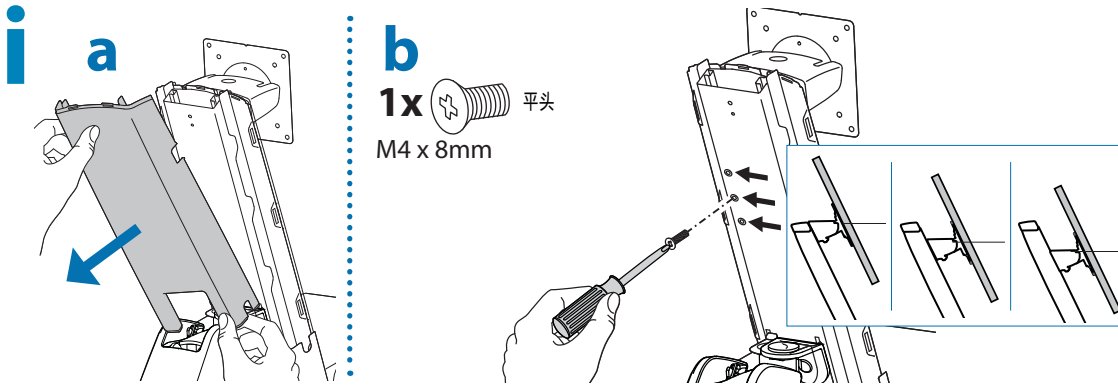

汉语

6

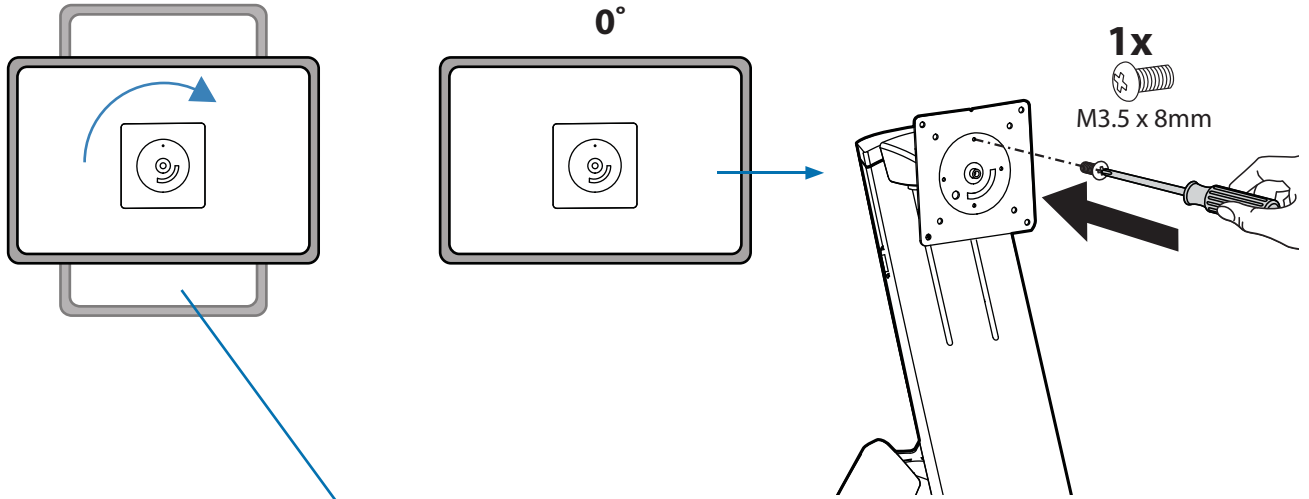

7

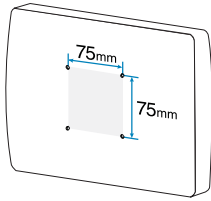

75mm

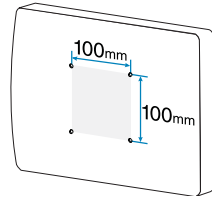

100mm

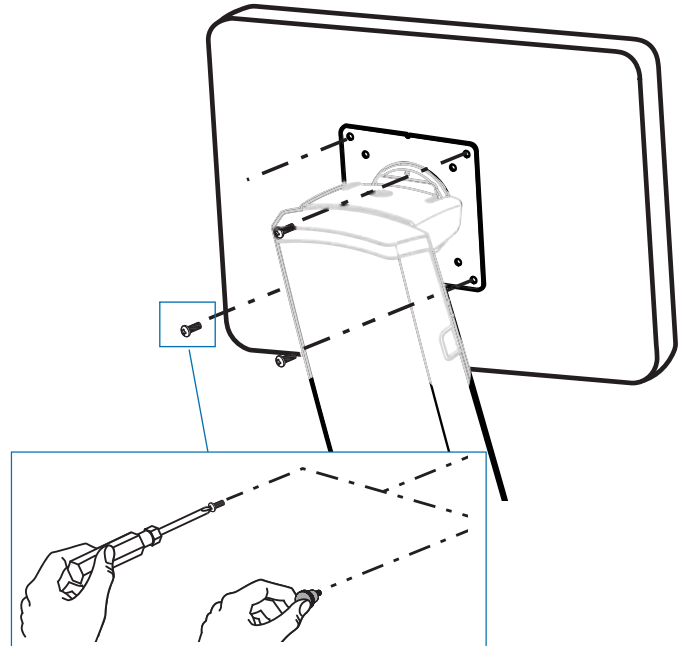
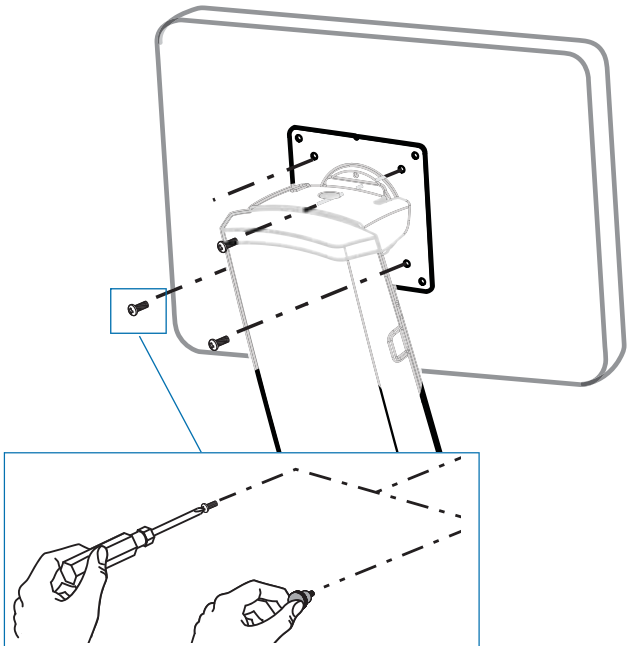
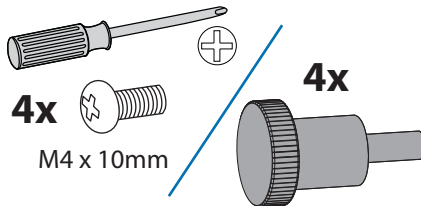

8



注：保持线缆有足够的松弛度以便全方位移动。



小心：

为了避免夹住线缆，请务必遵守本手册中的布线说明。不遵守本警告指示可能导致设备损坏或人身伤害。

a

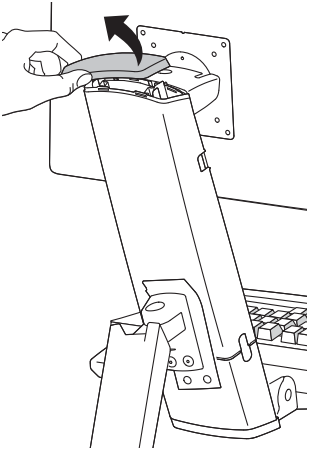

b

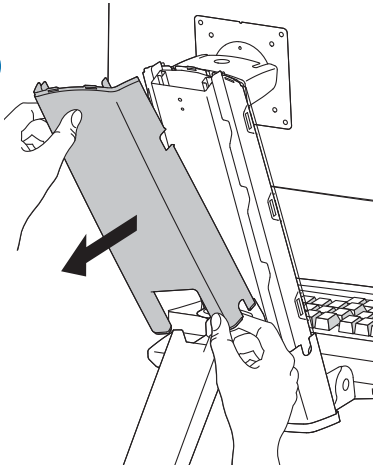

c

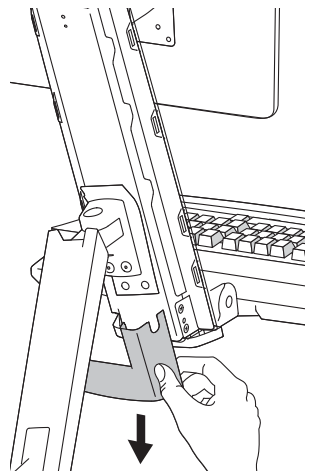

d

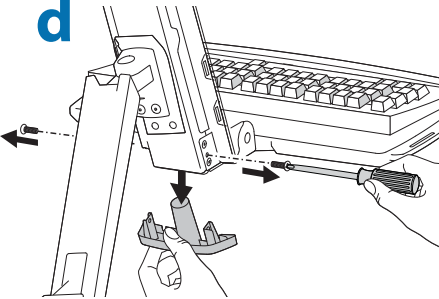

e

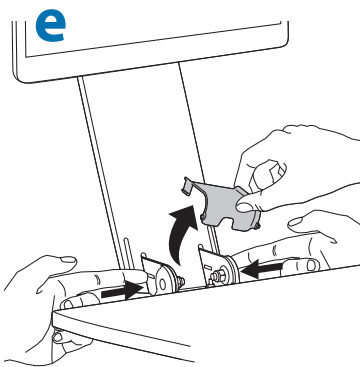

f

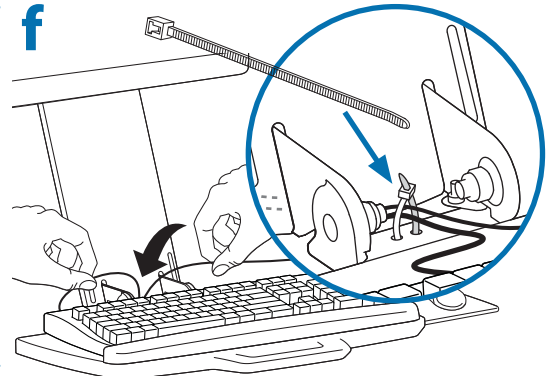

g

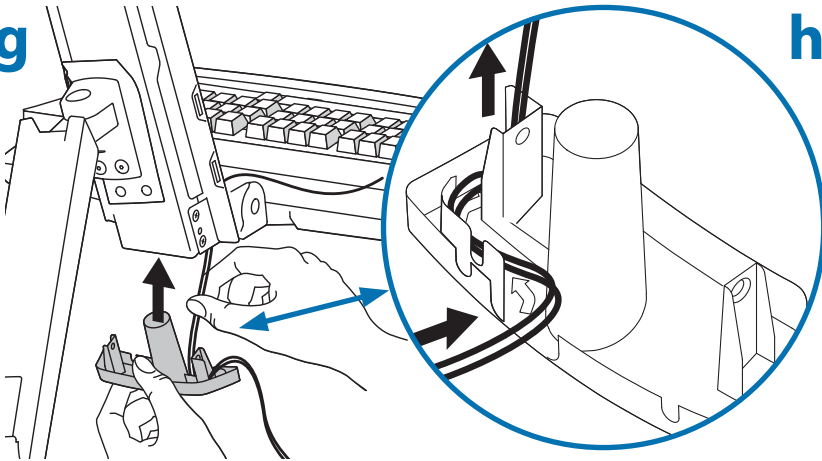

h

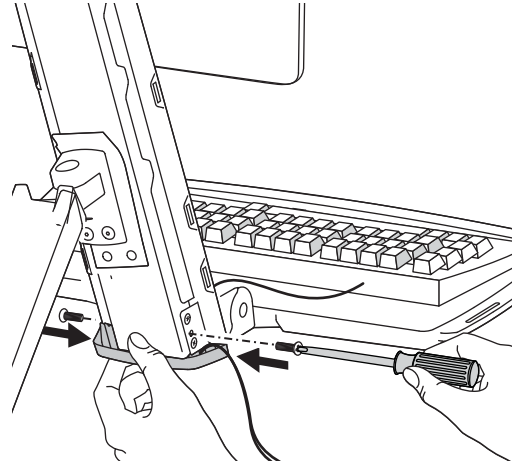

i

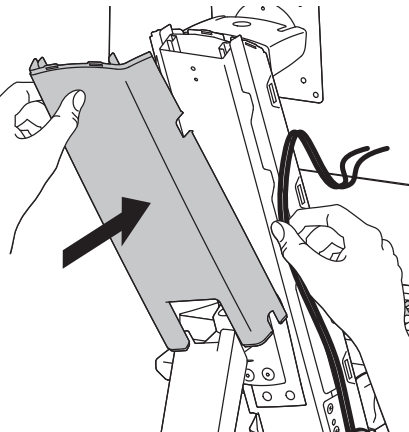

j

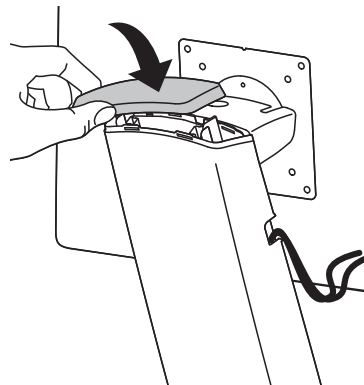

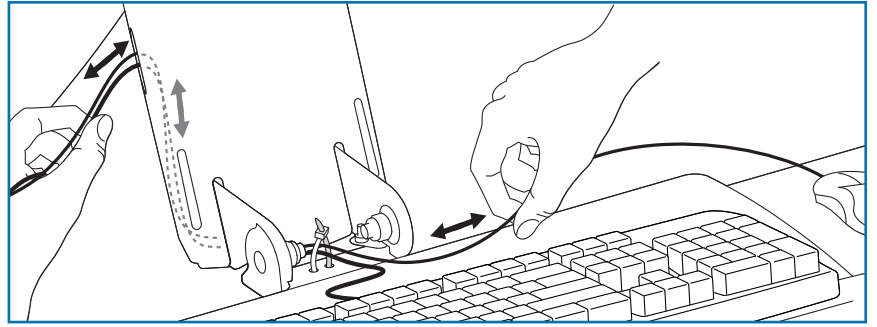
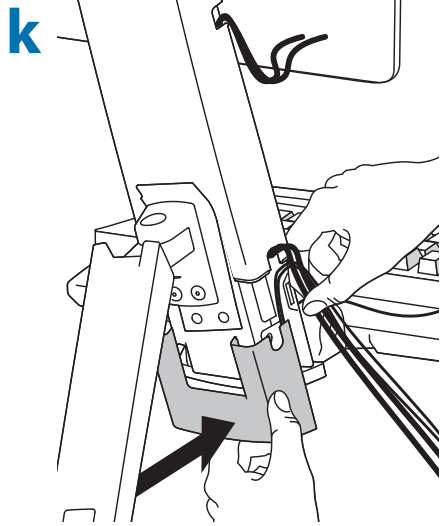

注意：请确保电缆能从盖板和电缆槽中推进拉出。

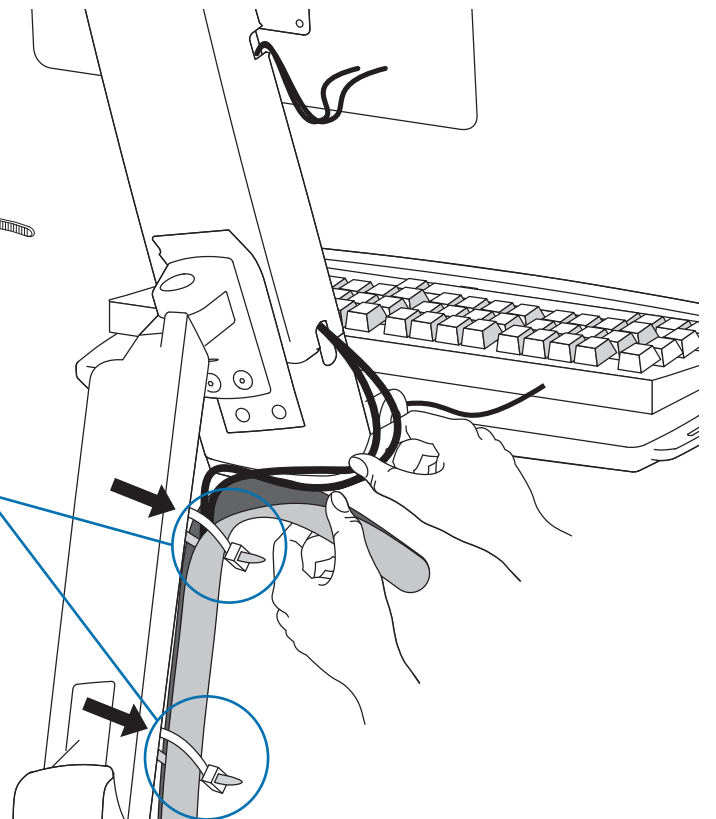
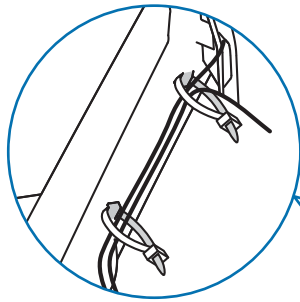
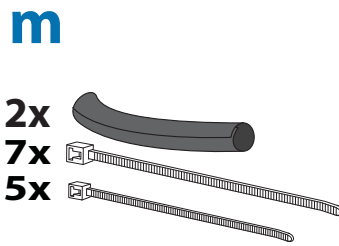
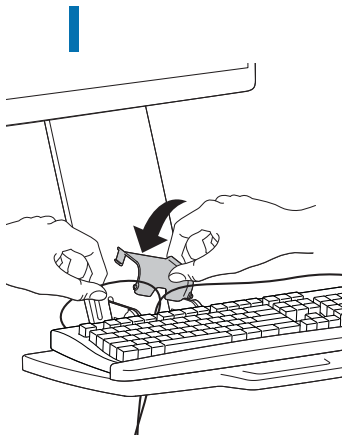

9

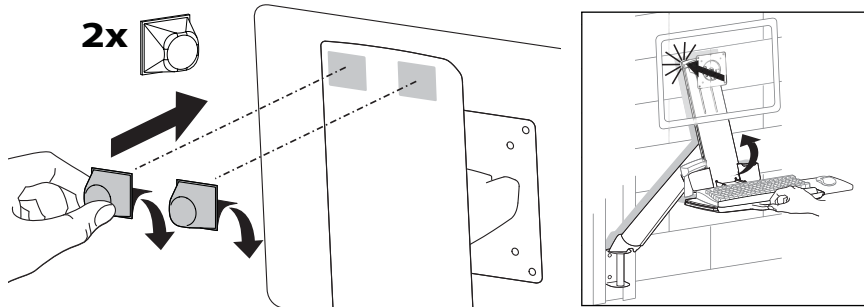

10

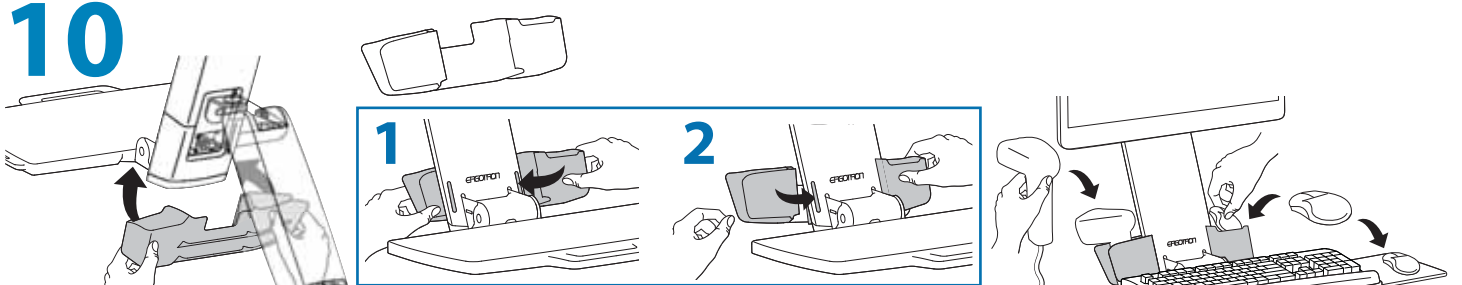

11



调整步骤

重要说明！本产品安装完成后需要调节。在尝试进行调节之前，确保所有设备都正确安装在产品上。本产品应能在整个动作范围内灵活自如地移动，并能固定在所设定的位置。如果移动过于容易或过于困难，或者产品不能固定在想要的位置上，请按照调节说明操作，使动作灵活自如。根据您所用产品及调节方式，可能需要旋转几圈后才能注意到差别。每次添加或者从本产品上拆除设备时，都会使安装负荷重量发生变化，您应该重复调节步骤，确保运行状态安全、最佳。



升降（上下）

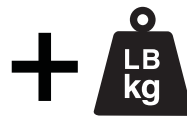
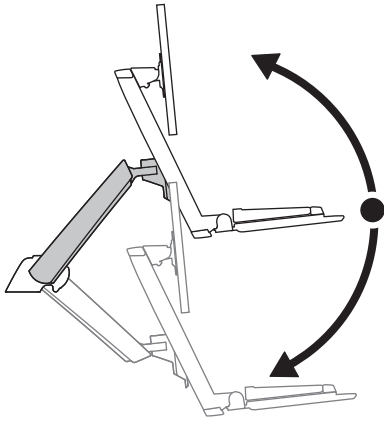

增大升力

如果安装重量过重，或者升起本产品时，产品不停留在升起位置，那么您需要增大升力：



减小升力

如果安装重量过轻，或者降下本产品时，产品不停留在降下位置，那么您需要减小升力：

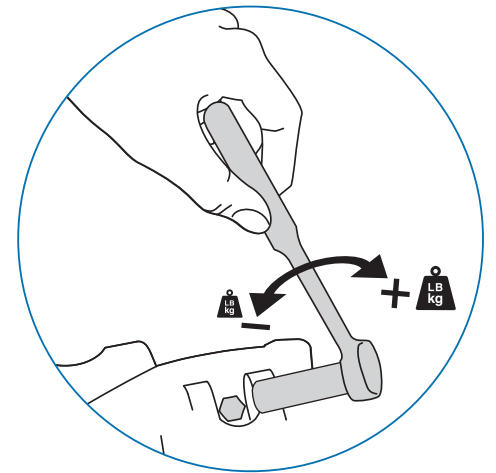
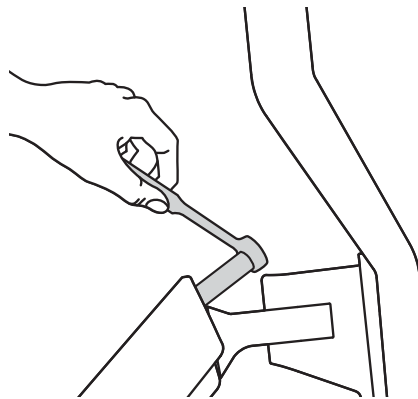
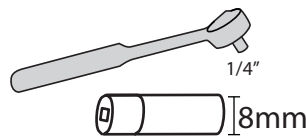



升降 (上下)



增大升力

如果安装重量过重, 或者升起本产品时, 产品不停留在升起位置, 那么您需要增大升力:



减小升力

如果安装重量过轻, 或者降下本产品时, 产品不停留在降下位置, 那么您需要减小升力:

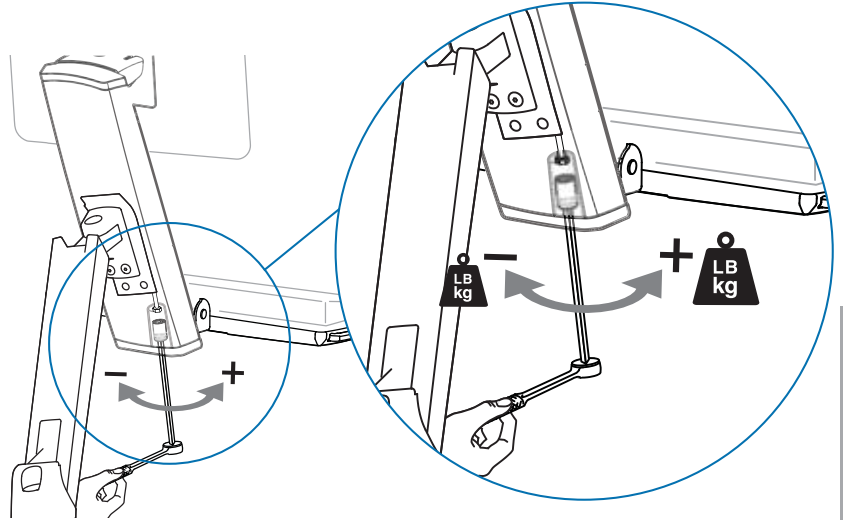
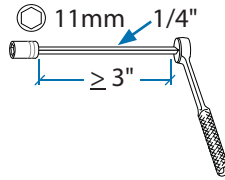
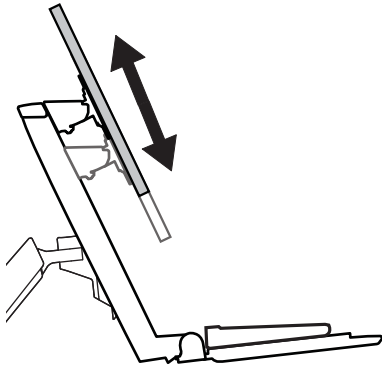

汉语



倾斜 (前后)



增加摩擦力

如果该产品太易于移动, 那么您将需要增加摩擦力:



减少摩擦力

如果该产品太难于移动, 那么您将需要降低摩擦力:

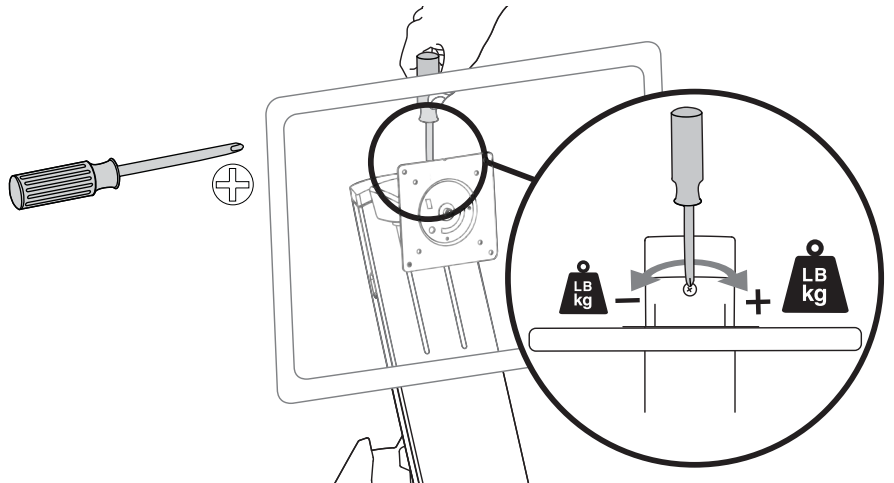
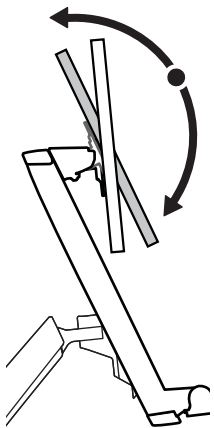



摆动。(左右)

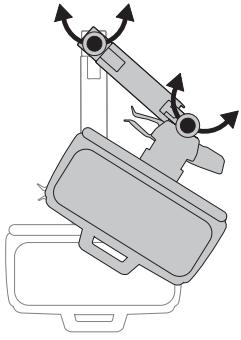

增加摩擦力
如果该产品太易于移动，那么您将需要增加摩擦力：



减少摩擦力
如果该产品太难于移动，那么您将需要降低摩擦力：

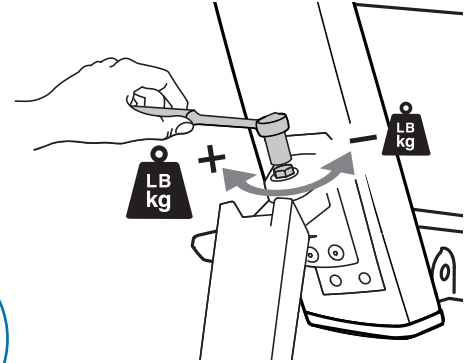
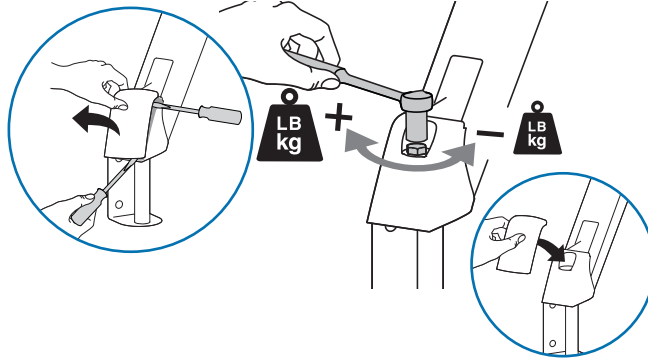
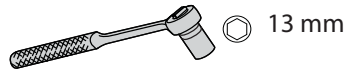

汉语



键盘存放

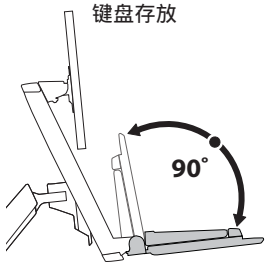

键盘使用

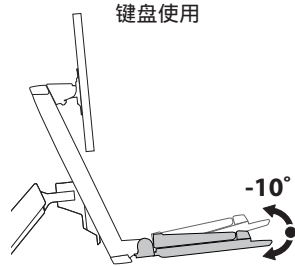

设置键盘角度 (最大负 10 度)

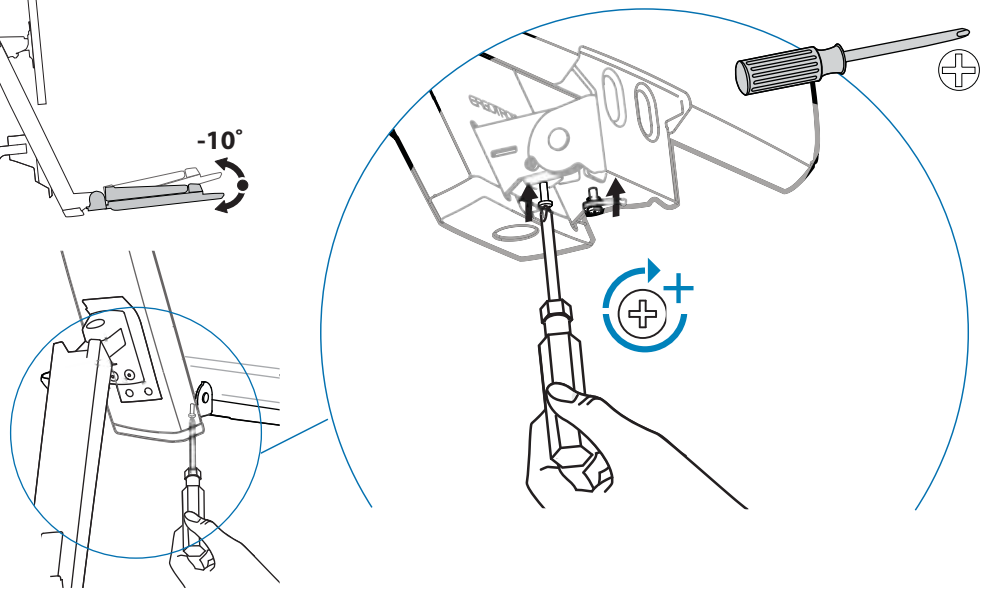

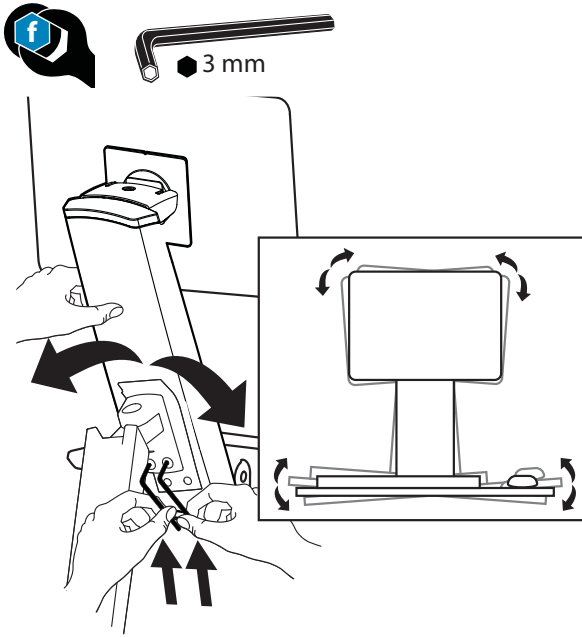

按照您自身的需要设置工作站！

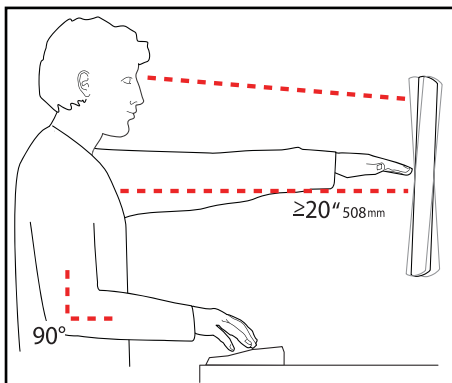

想进一步了解以符合人体工程学的方式使用计算机的知识，请访问：
www.computingcomfort.org

- 高度** 屏幕顶端的位置要稍低于视线高度。
将键盘放置在大约肘部的高度并且手腕要能放平。
- 距离** 将屏幕摆放在在距离面部一臂长的位置——至少 508mm (20")。
键盘的位置要够近，以使肘部形成直角。
- 角度** 倾斜屏幕以消除眩光。
将键盘向后倾斜 10 度，使手腕能保持放平。

为了减轻疲劳

- 呼吸 - 通过鼻子深呼吸。
- 眨眼 - 经常眨眼可避免眼睛干涩。
- 休息 - 每隔 20 分钟休息 2 至 3 分钟
- 每隔 2 小时休息 15 至 20 分钟。

有关服务和保修，请访问 www.ergotron.com

若需当地客户服务电话号码，请访问：<http://contact.ergotron.com>



© 2014 Ergotron, Inc.
All rights reserved.

While Ergotron, Inc. makes every effort to provide accurate and complete information on the installation and use of its products, it will not be held liable for any editorial errors or omissions (including those made in the process of translation from English to another language), or for incidental, special or consequential damages of any nature resulting from furnishing this instruction and performance of equipment in connection with this instruction. Ergotron, Inc. reserves the right to make changes in the product design and/or product documentation without notification to its users. For the most current product information, or to know if this document is available in languages other than those herein, please contact Ergotron. No part of this publication may be reproduced, stored in a retrieval system, or transmitted in any form or by any means, electronic, mechanical, photocopying, recording or otherwise without the prior written consent of Ergotron, Inc., 1181 Trapp Road, Eagan, Minnesota, 55121, USA. Patents Pending and Patented U.S. & Foreign. Ergotron is a registered trademark of Ergotron, Inc.

Americas Sales and Corporate Headquarters
St. Paul, MN USA
(800) 888-8458
+1-651-681-7600
www.ergotron.com
sales@ergotron.com

EMEA Sales
Amersfoort, The Netherlands
+31 33 45 45 600
www.ergotron.com
info.eu@ergotron.com

APAC Sales
Tokyo, Japan
www.ergotron.com
apaccustomerservice@ergotron.com

Worldwide OEM Sales
www.ergotron.com
info.oem@ergotron.com