

经济型脚杯

固定调节型 · 圆形带橡胶垫 中载型

代码	类型	材质		表面处理	
		螺杆	底座	螺杆	底座
E-WAC53	固定调节型	S45C	Q235+PVC(黄色)	镀铬	镀铬
E-WAC61				镀锌	镀铬
E-WAC63				镀锌	镀锌
E-WAC54				镀锌	镀锌
E-WAC62				镀锌	镀铬
E-WAC64	圆形带橡胶垫	S45C	Q235+PVC(黑色)	镀铬	镀铬
E-WAC65				镀锌	镀铬
E-WAC59				镀锌	镀锌
E-WAC65	圆形无橡胶垫	SUS304	Q235	镀锌	镀锌
E-WAC57				镀锌	镀锌
E-WAC58	圆形带橡胶垫	SUS304	SUS304+PVC(黄色)	镀锌	镀锌
E-WAC60				镀锌	镀铬
E-WAC60	圆形无橡胶垫	SUS304	SUS304	—	—



D: 60/80 (无定位孔)

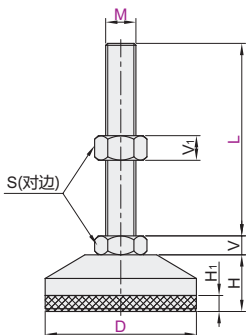

D: 100/120/150 (带定位孔)

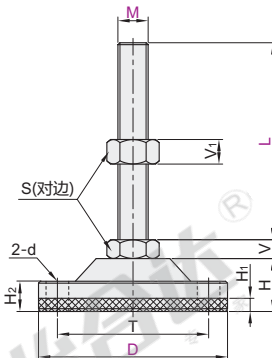

视角标准：第一视角

型号	D	M	L	S	H	H ₁	H ₂	V	V ₁	T	d	承载 (Kg)	参考重量 (Kg/pcs)					
E-WAC53 E-WAC54 E-WAC57 E-WAC58 E-WAC59 E-WAC60 E-WAC61 E-WAC62 E-WAC63 E-WAC64 E-WAC65	10	75	17					7	8			500	0.31					
		100										0.32						
		125	19					8	10			600	0.37					
	60	16	125	24					10	13			700	0.39				
			150	27.5	6.5								0.4					
			200										0.45					
		20	100											0.51				
			125											0.56				
			150	30					13	16			800	0.59				
	E-WAC53 E-WAC54 E-WAC57 E-WAC58 E-WAC59 E-WAC60 E-WAC61 E-WAC62 E-WAC63 E-WAC64 E-WAC65	12	100	19					8	10			700	0.63				
			125										0.68					
			150										0.68					
80		16	125	24					10	13			800	0.7				
			150	30	8.5								0.66					
			200										0.7					
		20	100											0.68				
			125											0.71				
			150	30					13	16			850	0.75				
E-WAC53 E-WAC54 E-WAC57 E-WAC58 E-WAC59 E-WAC60 E-WAC61 E-WAC62 E-WAC63 E-WAC64 E-WAC65		100	100	19					8	10			800	0.8				
			125										0.67					
			150										0.69					
	100	16	125	24					10	13			900	0.75				
			150	28	7	16							80	12	900	0.8		
			200											0.83				
		20	100											0.8				
			125											0.85				
			150	30					13	16			950	0.9				
	E-WAC53 E-WAC54 E-WAC57 E-WAC58 E-WAC59 E-WAC60 E-WAC61 E-WAC62 E-WAC63 E-WAC64 E-WAC65	12	100	19					8	10			800	0.96				
			125										0.67					
			150										0.69					
150		24	125	36					10	13			900	0.8				
			150	33	11	22							16	19	125	13.5	1100	1.27
			200												0.83			
		30	100											0.8				
			125											0.85				
			150	46					13	16			1100	0.9				
E-WAC53 E-WAC54 E-WAC57 E-WAC58 E-WAC59 E-WAC60 E-WAC61 E-WAC62 E-WAC63 E-WAC64 E-WAC65		16	100	24					10	13			900	0.8				
			125										0.83					
			150										0.8					
	20	24	125	36					10	13			900	0.8				
			150	33	11	22							16	19	125	13.5	1100	1.27
			200												0.83			
		30	100											0.8				
			125											0.85				
			150	46					13	16			1100	0.9				
	E-WAC53 E-WAC54 E-WAC57 E-WAC58 E-WAC59 E-WAC60 E-WAC61 E-WAC62 E-WAC63 E-WAC64 E-WAC65	20	100	30					10	13			900	0.8				
			125										0.83					
			150										0.8					
30		24	125	36					10	13			900	0.8				
			150	33	11	22							16	19	125	13.5	1100	1.27
			200												0.83			
		46	100											0.8				
			125											0.85				
			150	46					13	16			1100	0.9				
E-WAC53 E-WAC54 E-WAC57 E-WAC58 E-WAC59 E-WAC60 E-WAC61 E-WAC62 E-WAC63 E-WAC64 E-WAC65		24	100	36					10	13			900	0.8				
			125										0.83					
			150										0.8					
	30	24	125	36					10	13			900	0.8				
			150	33	11	22							16	19	125	13.5	1100	1.27
			200												0.83			
		46	100											0.8				
			125											0.85				
			150	46					13	16			1100	0.9				
	E-WAC53 E-WAC54 E-WAC57 E-WAC58 E-WAC59 E-WAC60 E-WAC61 E-WAC62 E-WAC63 E-WAC64 E-WAC65	30	100	46					10	13			900	0.8				
			125										0.83					
			150										0.8					
46		24	125	36					10	13			900	0.8				
			150	33	11	22							16	19	125	13.5	1100	1.27
			200												0.83			
		60	100											0.8				
			125											0.85				
			150	46					13	16			1100	0.9				
E-WAC53 E-WAC54 E-WAC57 E-WAC58 E-WAC59 E-WAC60 E-WAC61 E-WAC62 E-WAC63 E-WAC64 E-WAC65		40	100	50					10	13			900	0.8				
			125										0.83					
			150										0.8					
	60	24	125	36					10	13			900	0.8				
			150	33	11	22							16	19	125	13.5	1100	1.27
			200												0.83			
		80	100											0.8				
			125											0.85				
			150	46					13	16			1100	0.9				
	E-WAC53 E-WAC54 E-WAC57 E-WAC58 E-WAC59 E-WAC60 E-WAC61 E-WAC62 E-WAC63 E-WAC64 E-WAC65	60	100	60					10	13			900	0.8				
			125										0.83					
			150										0.8					
80		24	125	36					10	13			900	0.8				
			150	33	11	22							16	19	125	13.5	1100	1.27
			200												0.83			
		100	100											0.8				
			125											0.85				
			150	46					13	16			1100	0.9				



型号	代码	D	M	L
E-WAC63	60	100	100	100
E-WAC54	60	100	100	100

请按图示订货 E-WAC53—D60—M10—L75



数量	1~9	10~
价格	100%	另行报价

未税价(元)



交货期

1